

HISTORICAL COLLECTION

WORLD WAR II



MITSUBISHI A6M2 "ZERO-SEN"

PLACE OF ORIGIN - JAPAN
IN SERVICE - 1940 - 1945
ROLE - FIGHTER
CREW - 1
WINGSPAN - 12m (39'4")
LENGTH - 9,1m (29'9")
HEIGHT - 3,53m (10')
WEIGHT - 2796kg (6164LB)
ENGINE - NAKAJIMA NK1C SAKAE-12
14-CYLINDER, 700kw (940KM)
RANGE - 1870km (1160MI, 1010NMI)
RATE OF CLIMB - 15,7m/s (3090FT/MIN)
MAXIMUM FLIGHT LEVEL - 10000m (33,000FT)
ARMAMENT - 2x 7.7mm (0.303") TYP 97 MG,
2x 20mm (0.787") TYP 99-1 Mk.3 CANNONS,
2x 60kg (132LB) BOMBS
MAXIMUM SPEED - 533km/h (331MPH)



5729

PAD PRINTED
NO STICKERS

Printed in EU

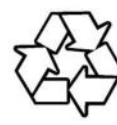

UK
CA CE



WARNING: CHOKING HAZARD-
Toy contains small parts.
Not for children under 3 years.

347 1  

MITSUBISHI A6M2 "ZERO-SEN"

SCALE 1:32

BE CAREFUL: NOTICE THE DIFFERENCE

A



B



UWAGA: RÓŻNE KLOCKI

1

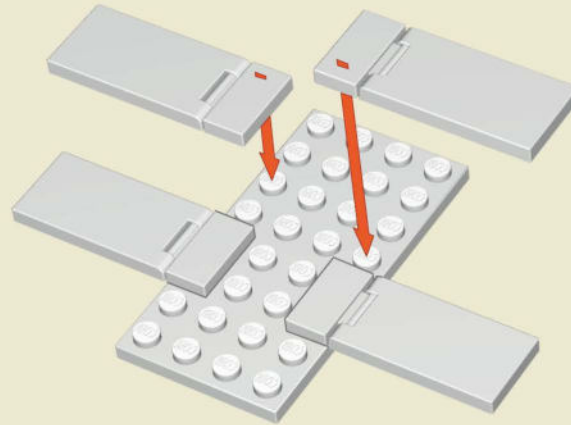
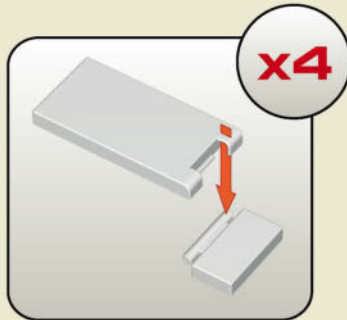

x1



x4



x4

2

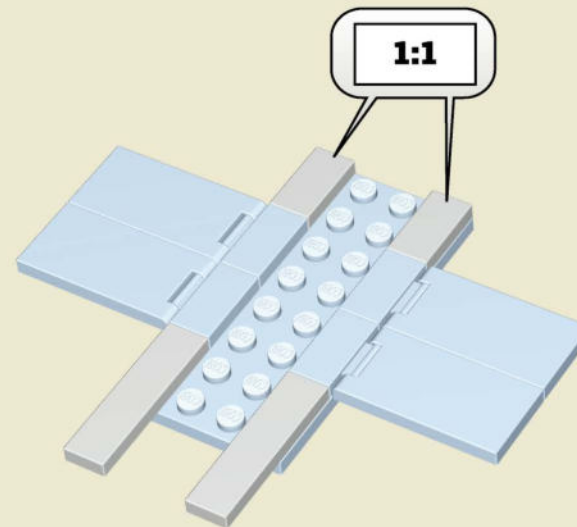
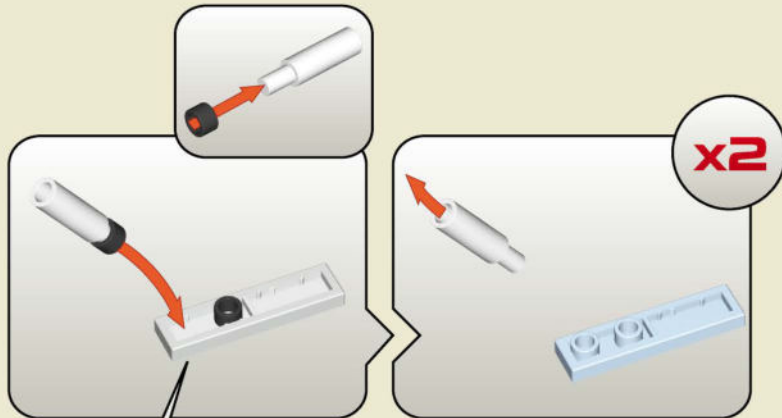

x2



x4



x2

1:1

3

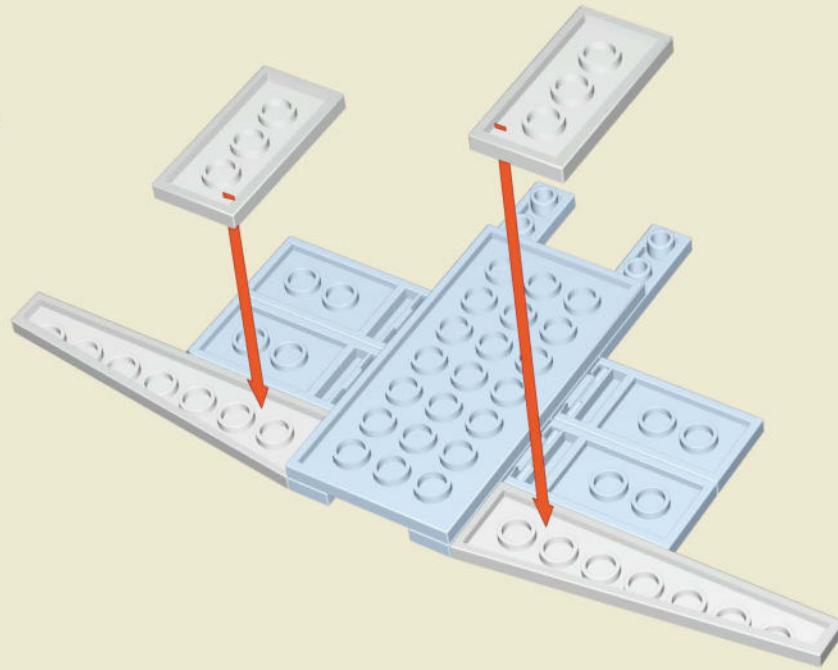

x1



x1



x2

4

1:1

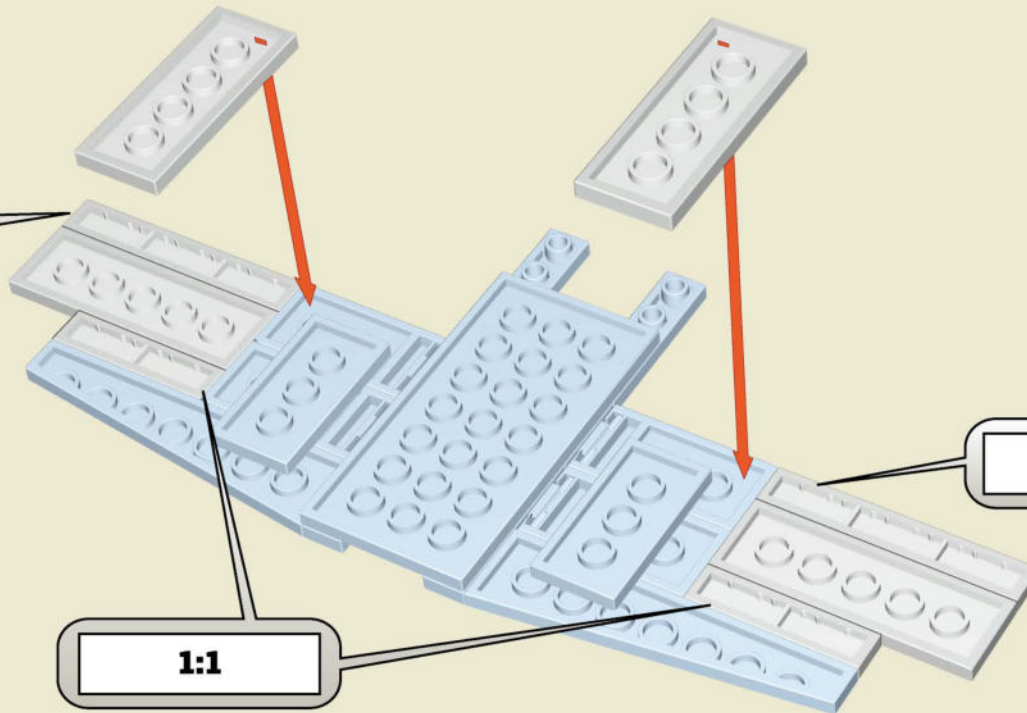

1:1

1:1



x2



x2



x2



x2

5

1:1

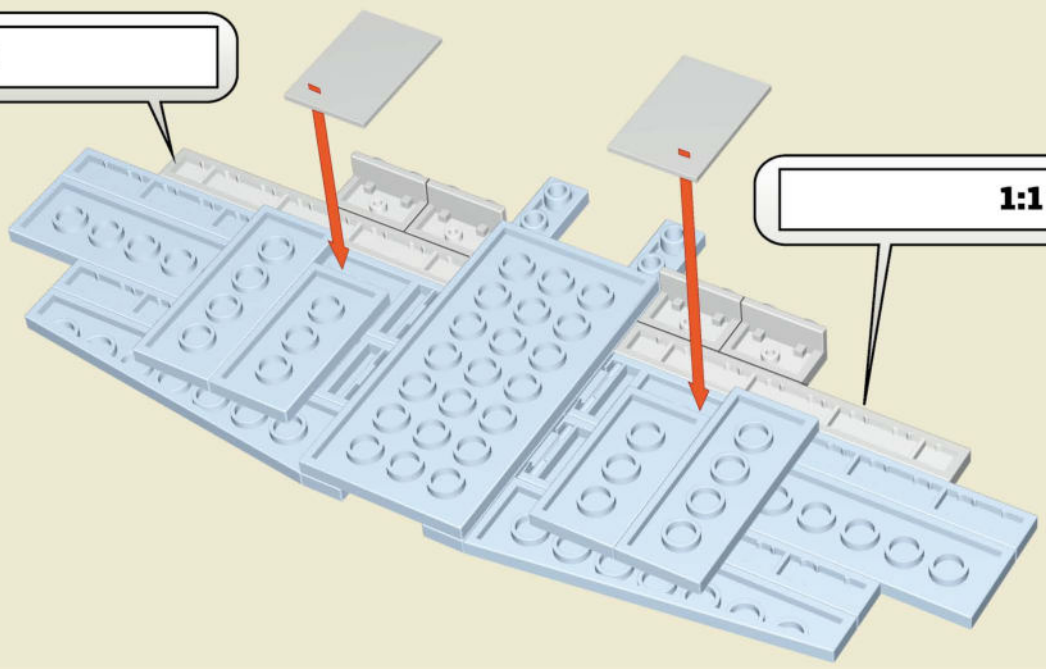



1:1

-  x2
-  x4
-  x2

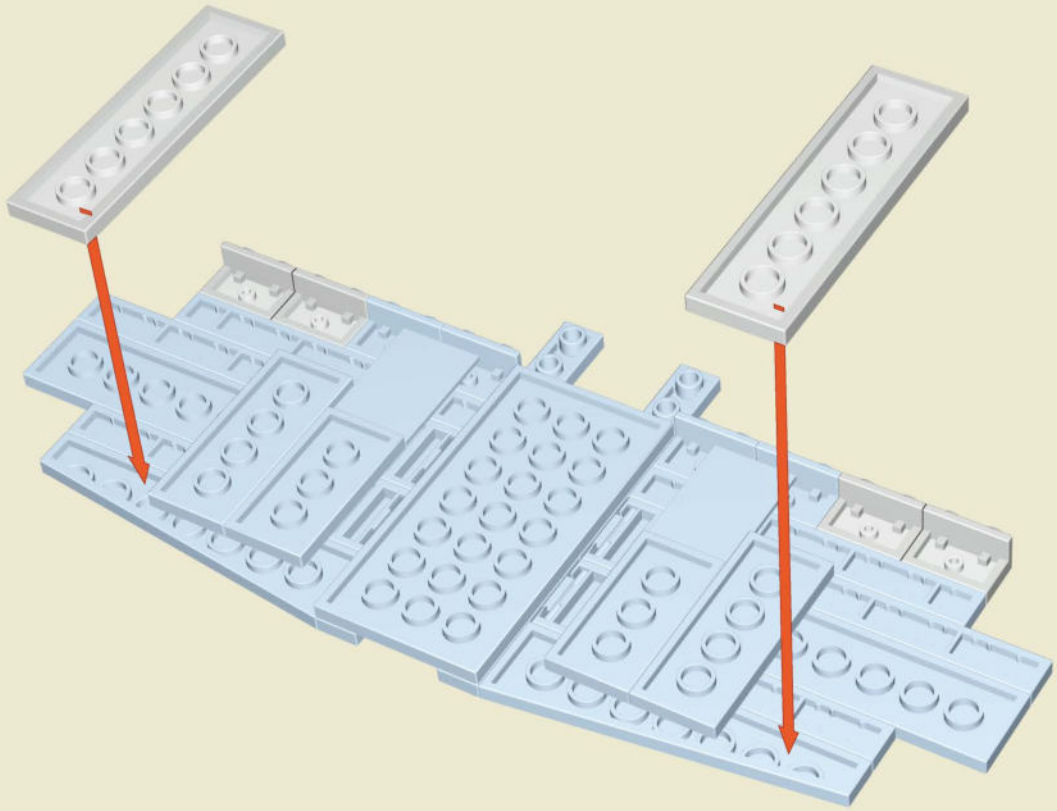
6



-  x4
-  x2

7

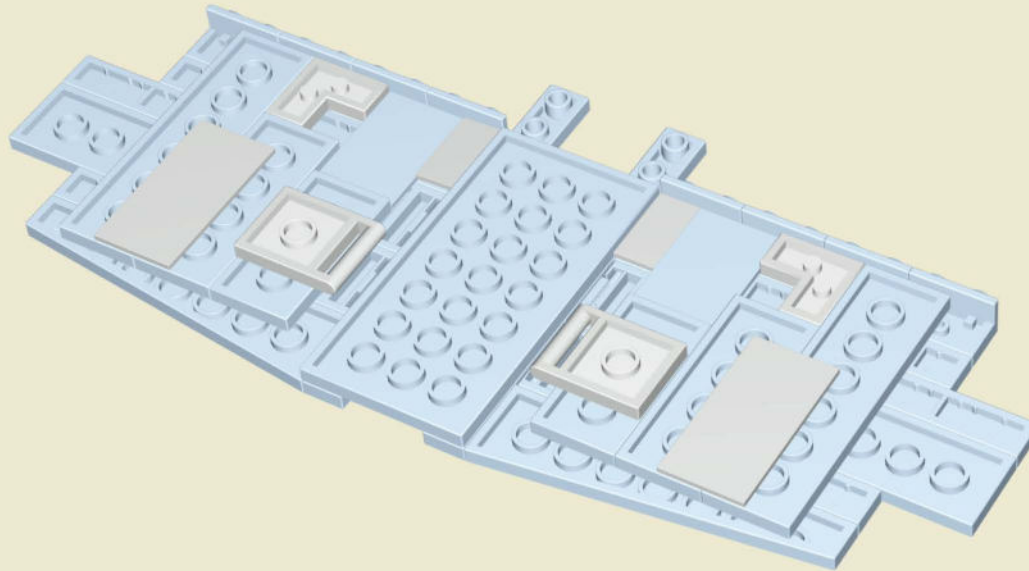

 x2

 x2

 x2

 x2

8

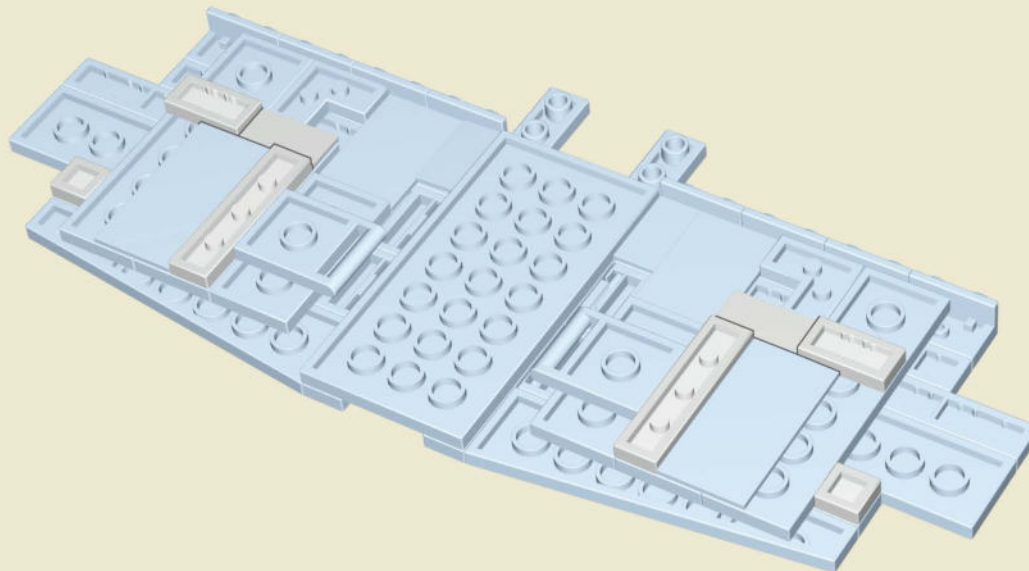

 x2

 x2

 x2

 x2

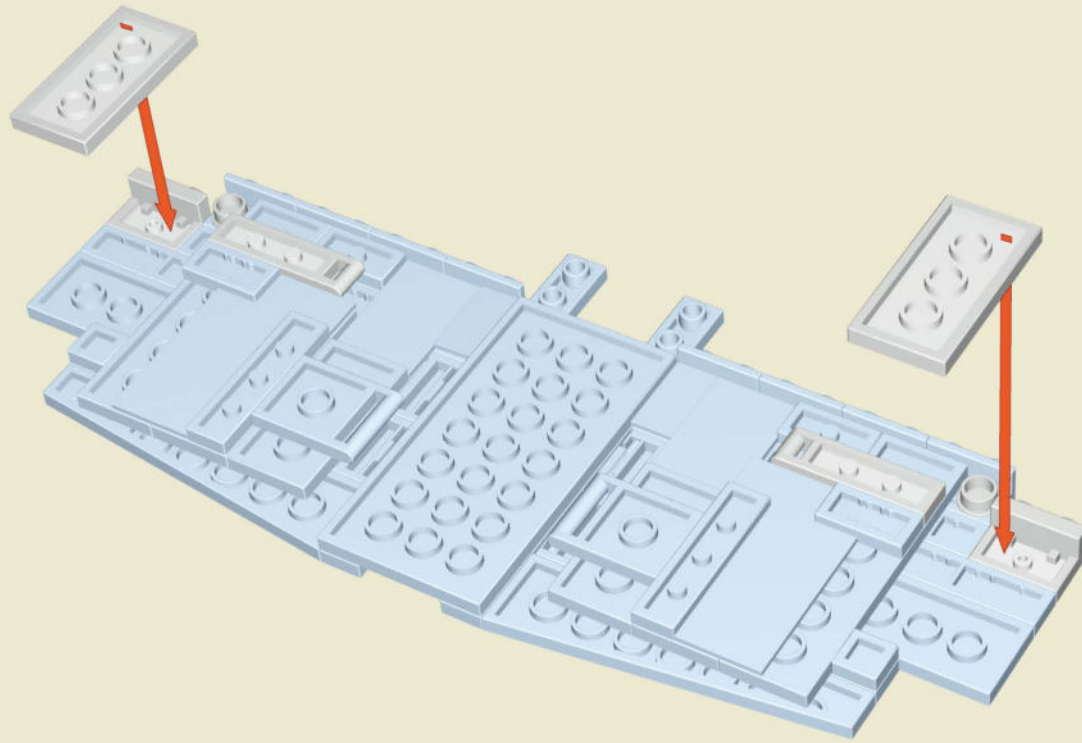

9

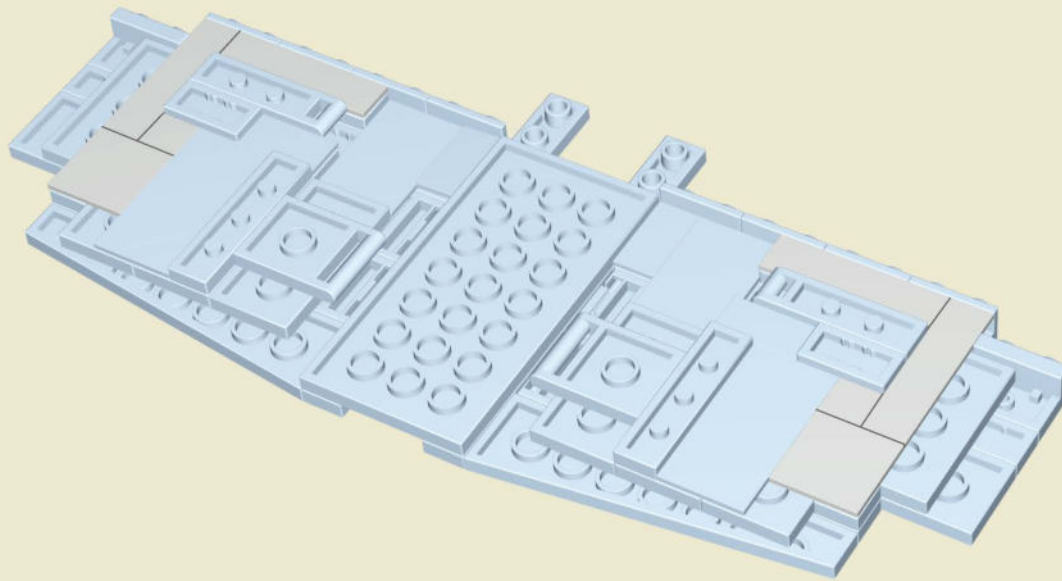

-  x2
-  x2
-  x2
-  x2

10



-  x4
-  x2
-  x2

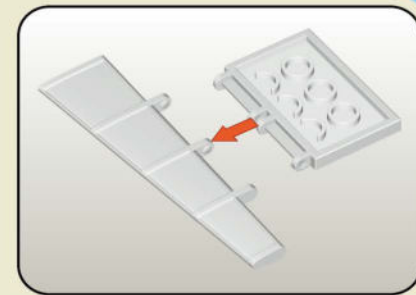
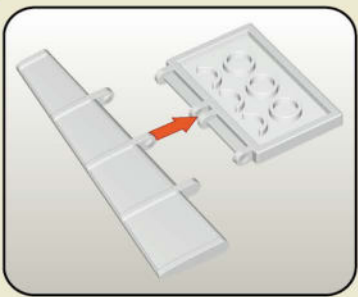

II

12

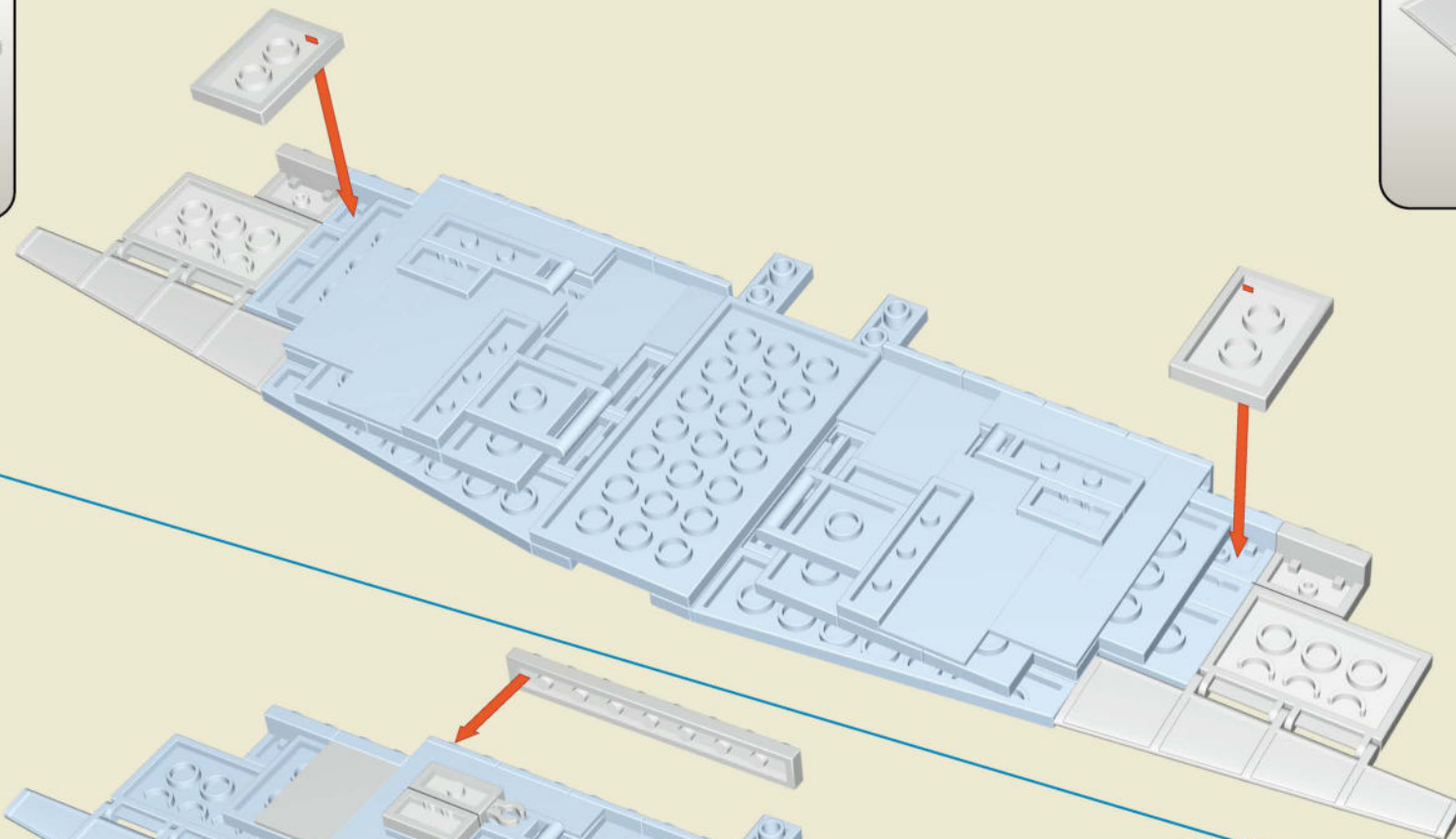

-  **x2**
-  **x2**
-  **x2**
-  **x2**

-  **x4**
-  **x2**
-  **x2**
-  **x2**

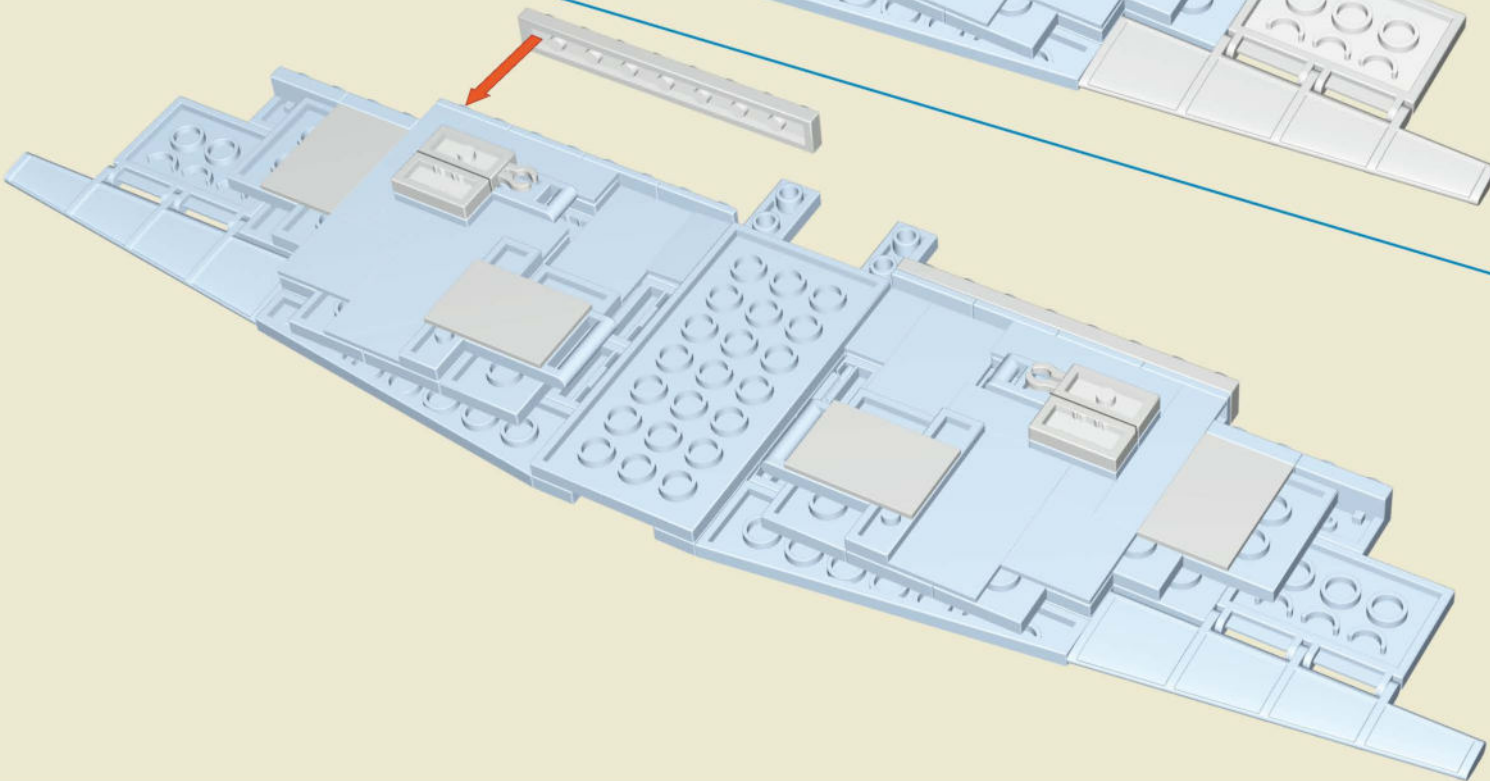

13

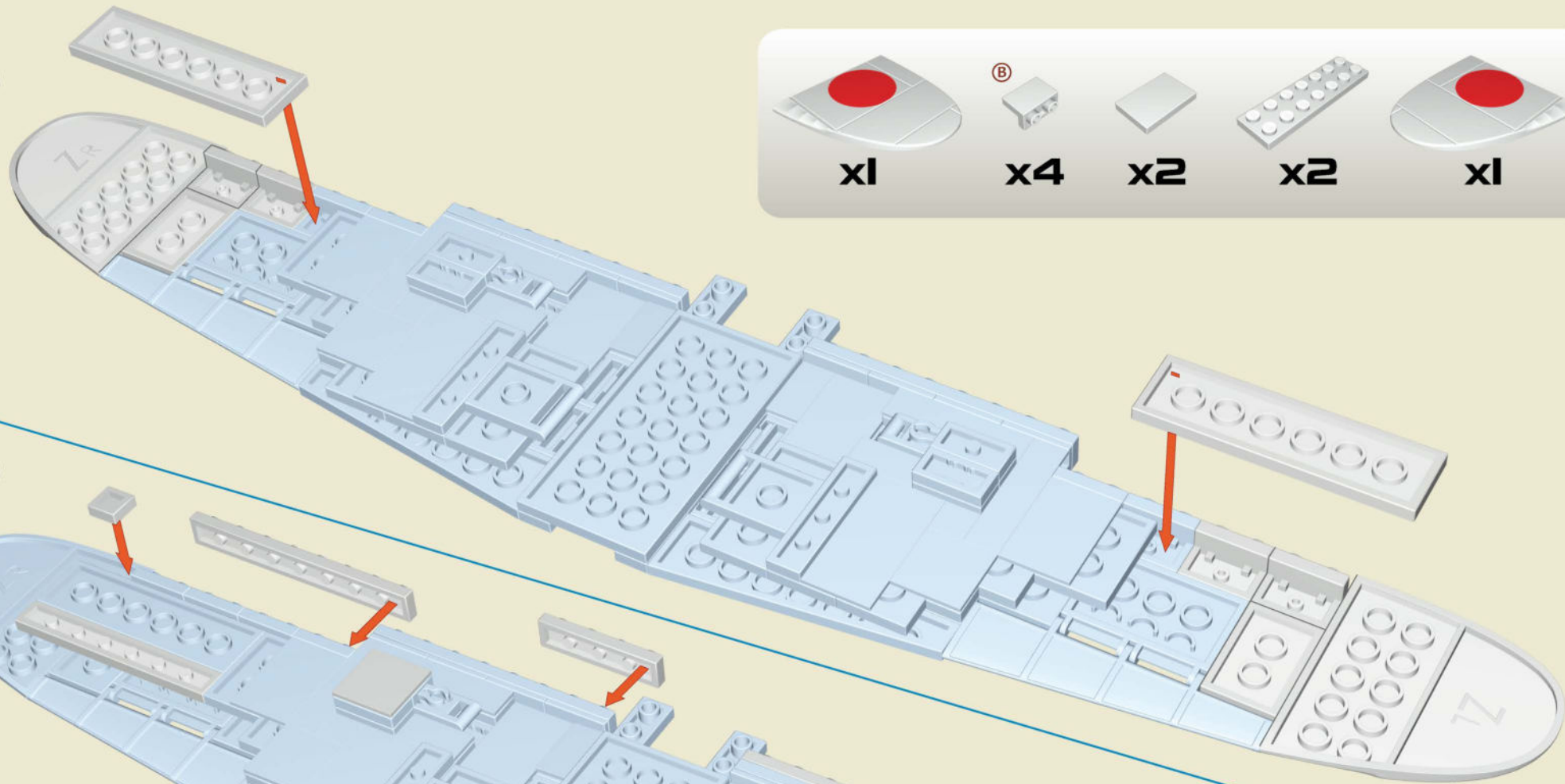

 **x1**
  **x4**
  **x2**
  **x2**
  **x1**

14

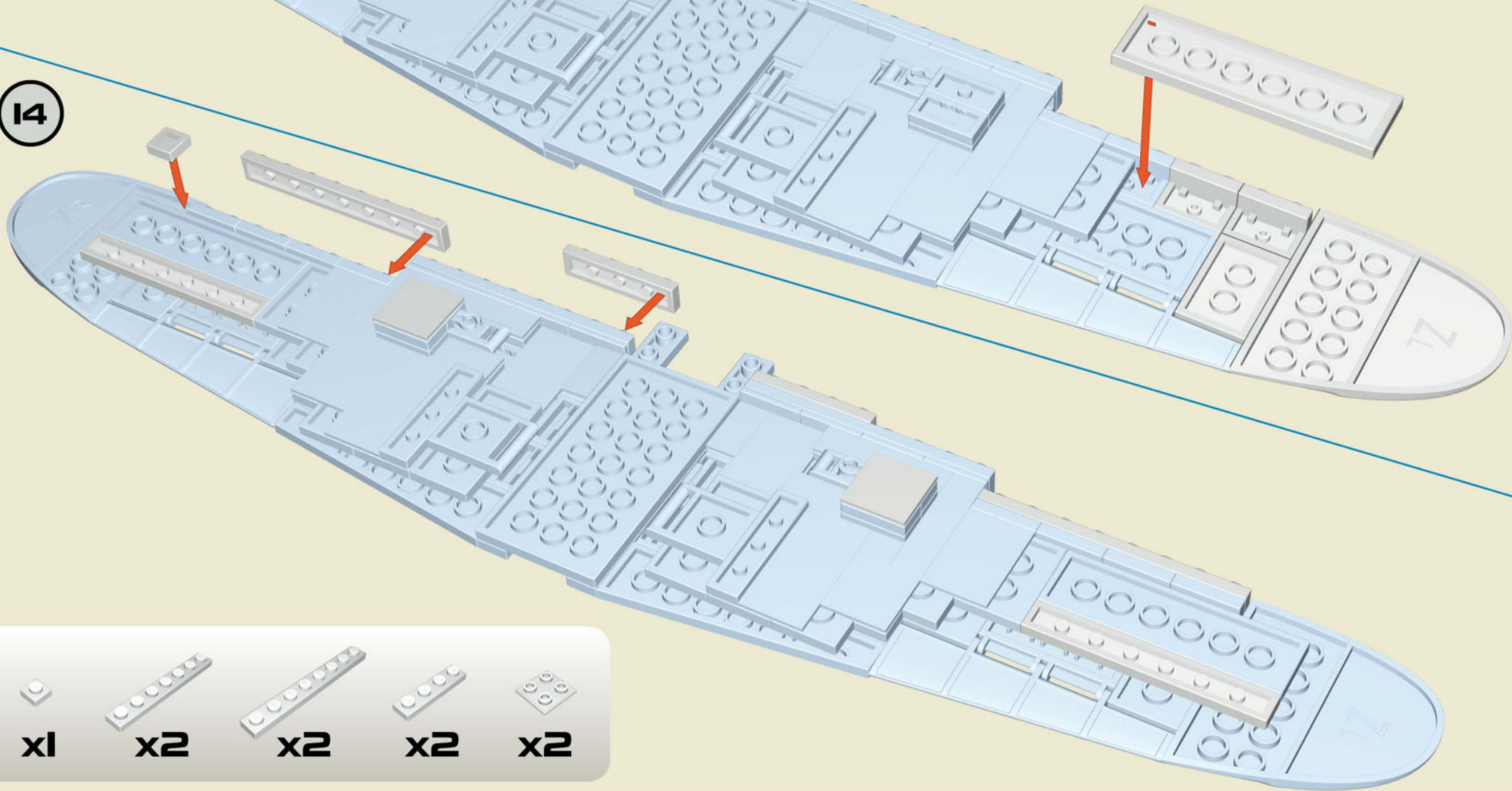

 **x1**
  **x2**
  **x2**
  **x2**
  **x2**

15

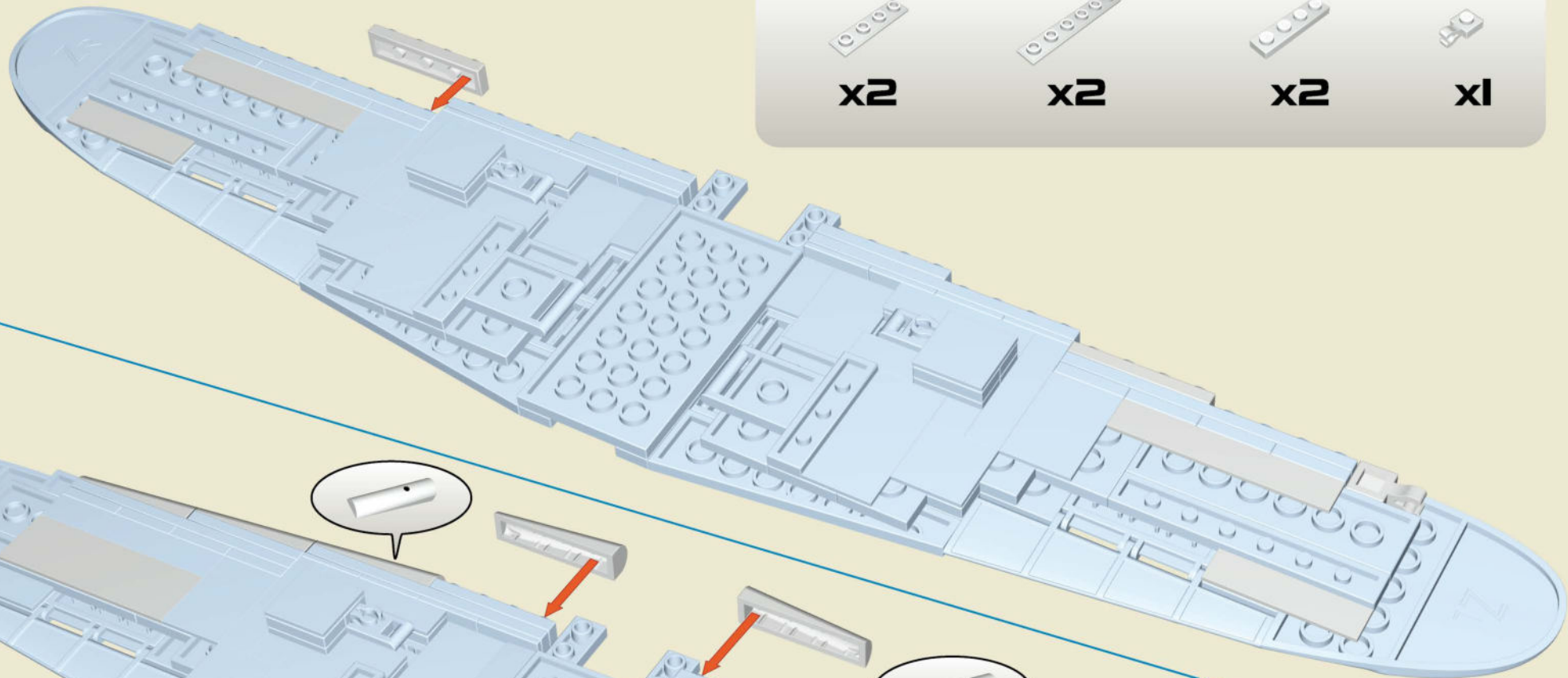



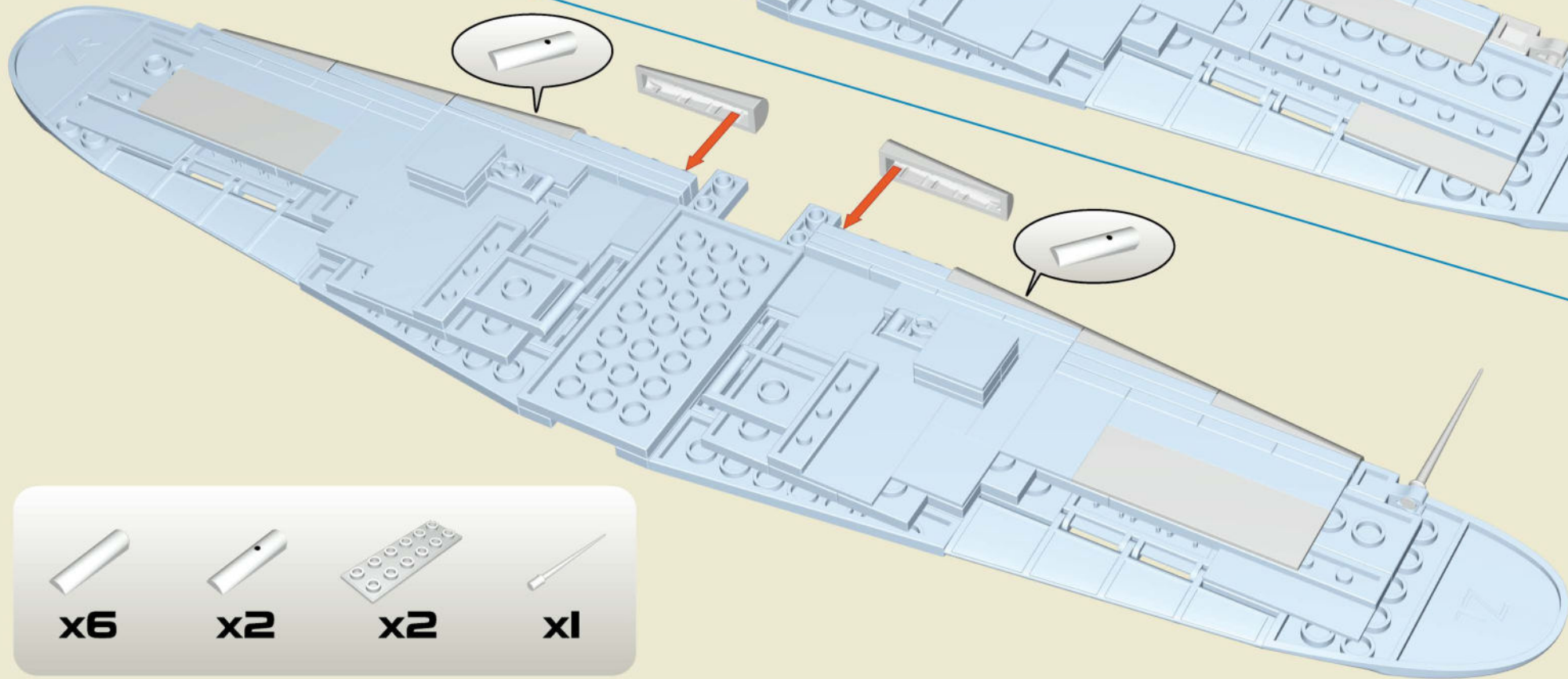

x2	x2	x2	x1

16

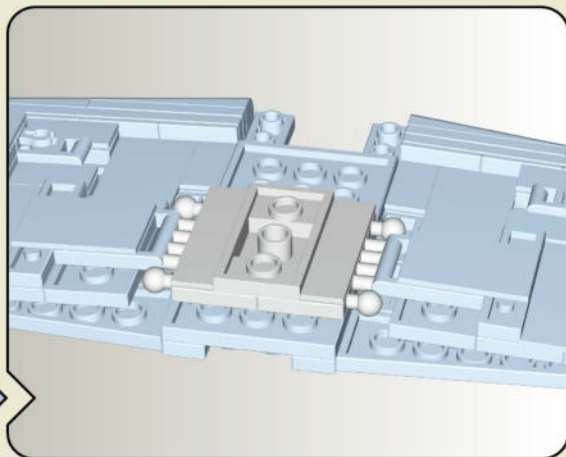
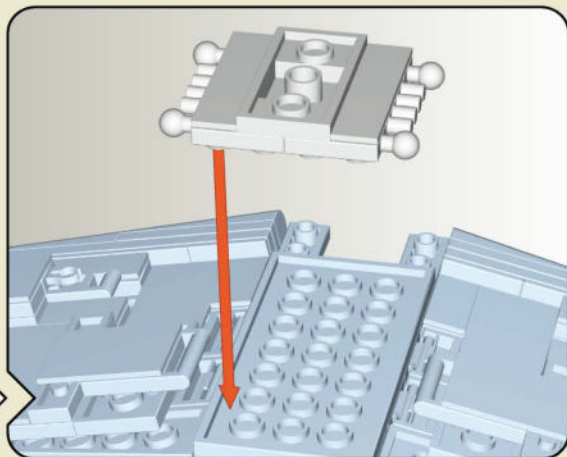
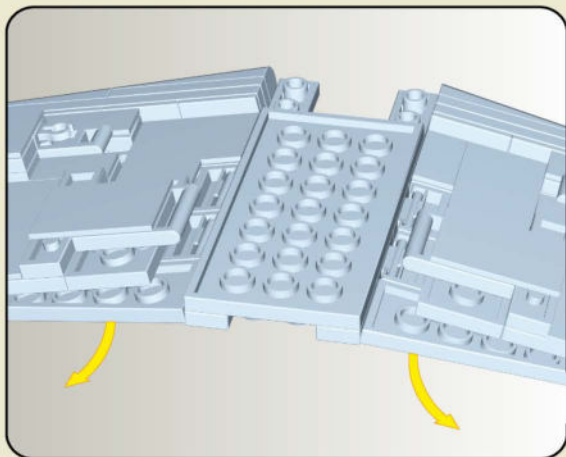

x6	x2	x2	x1



-  **x4**
-  **x1**
-  **x4**
-  **x2**

17

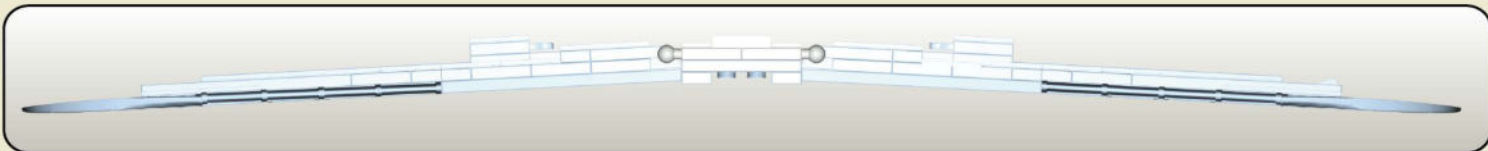
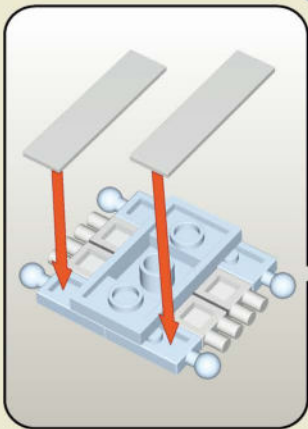
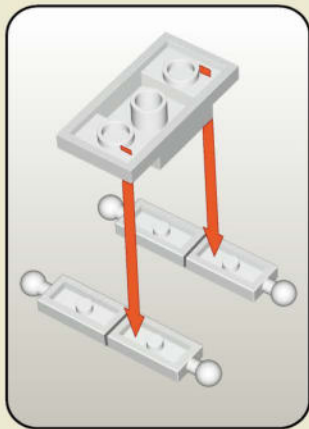
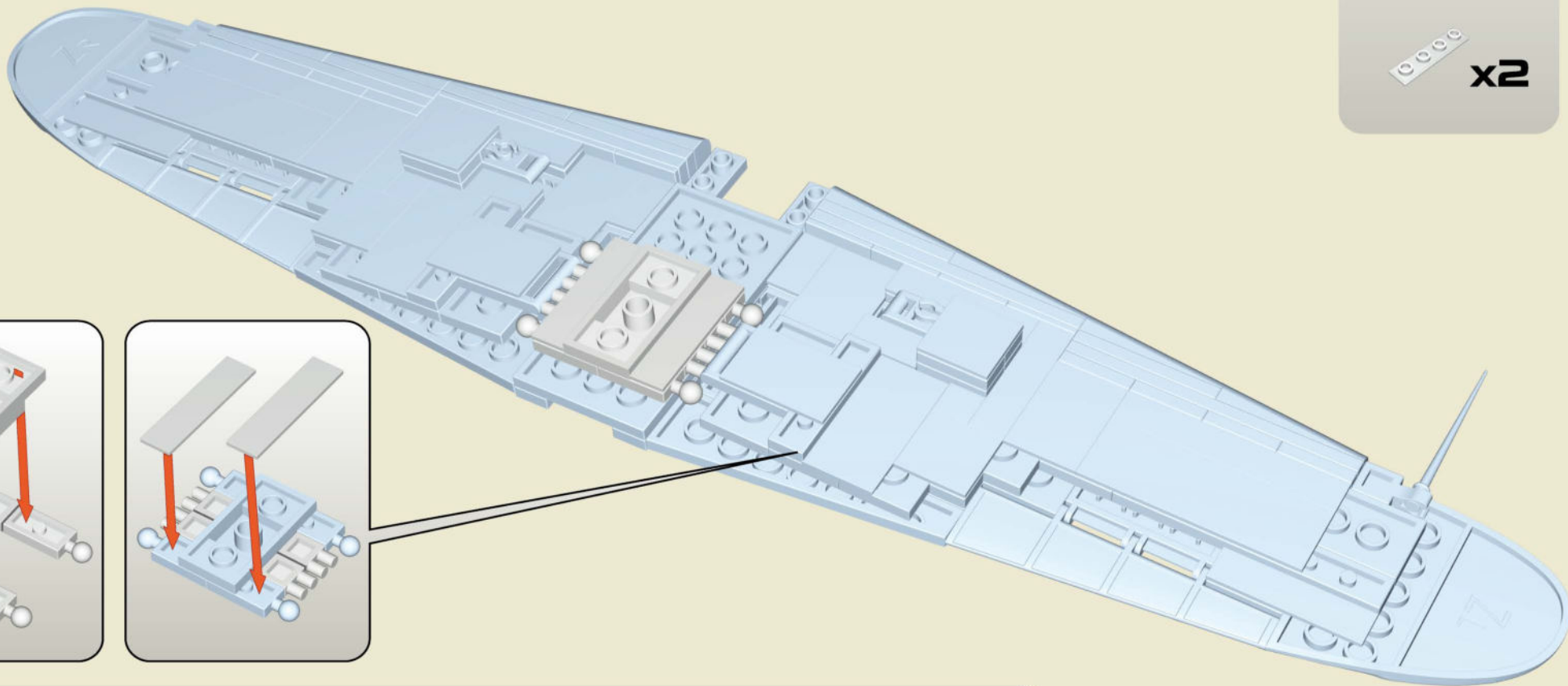

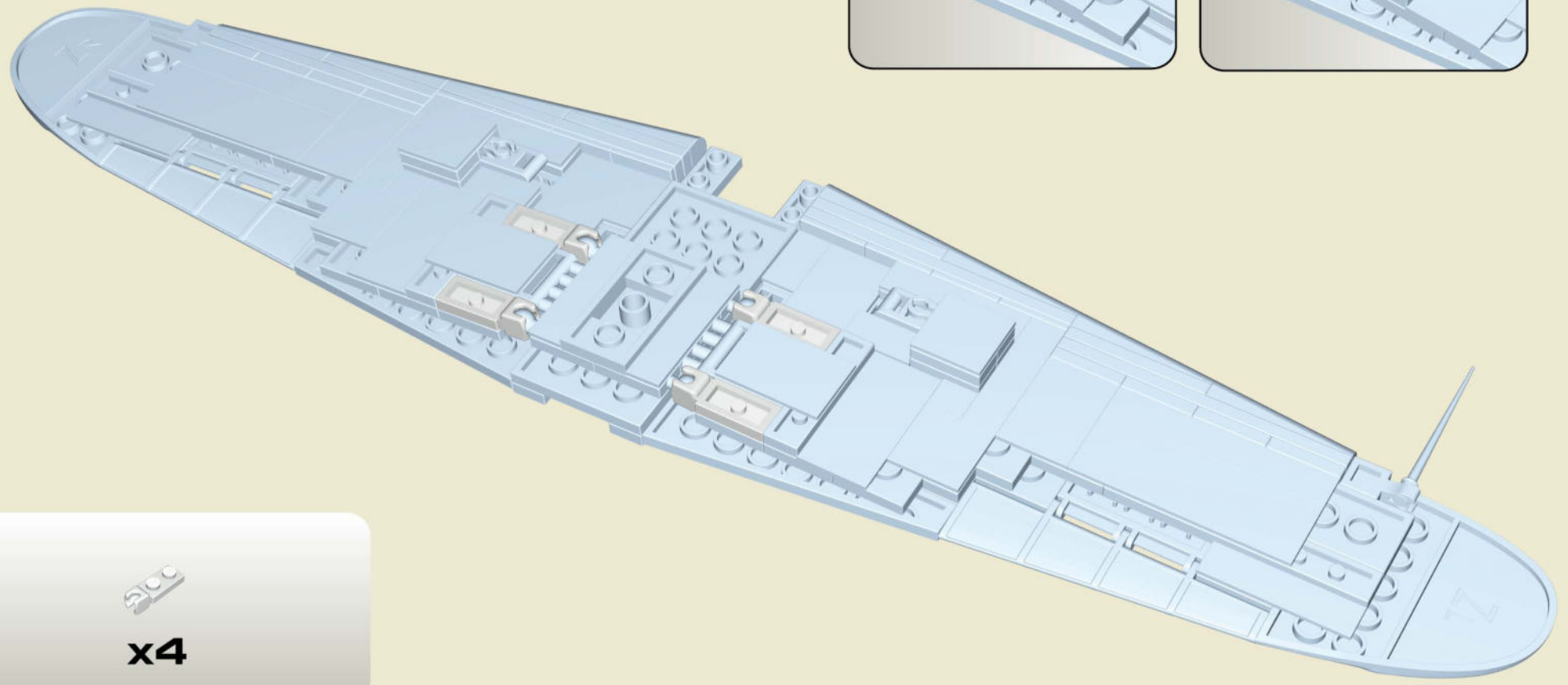
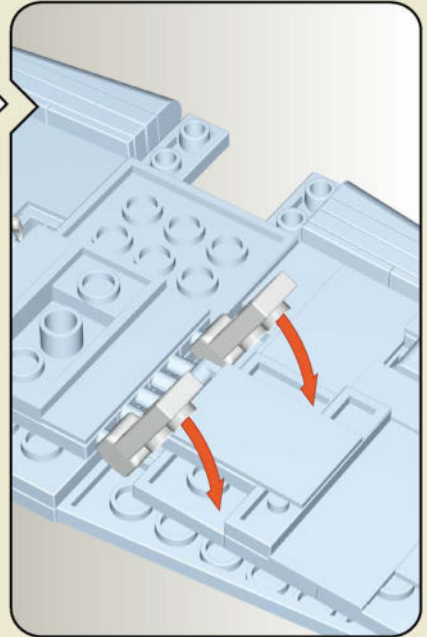
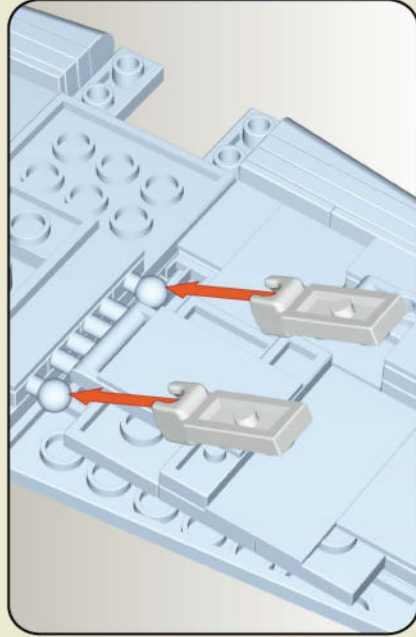

x4

19

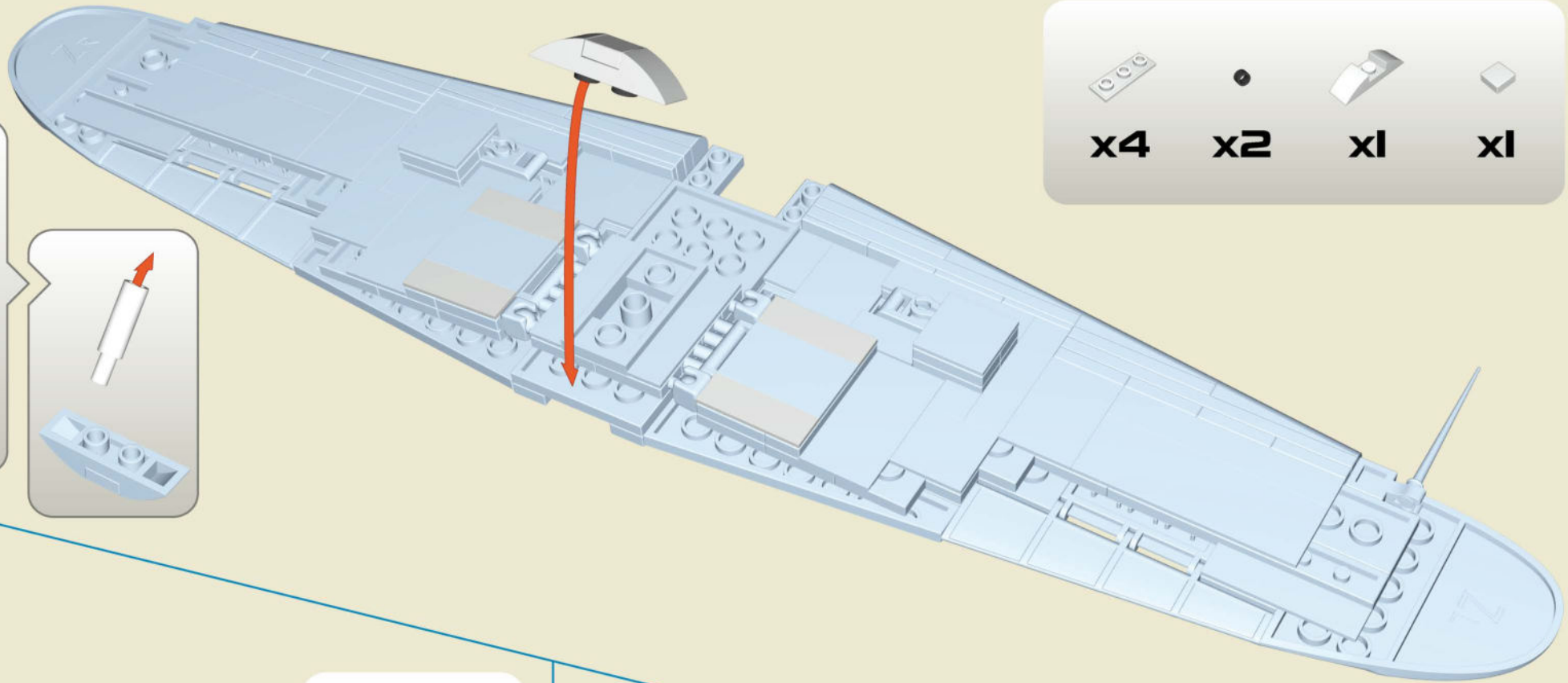
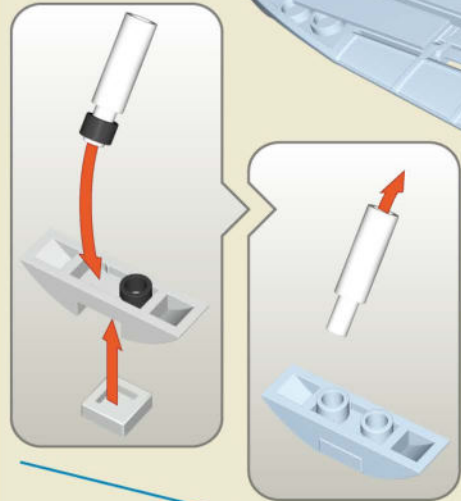

x4	x2	x1	x1

20

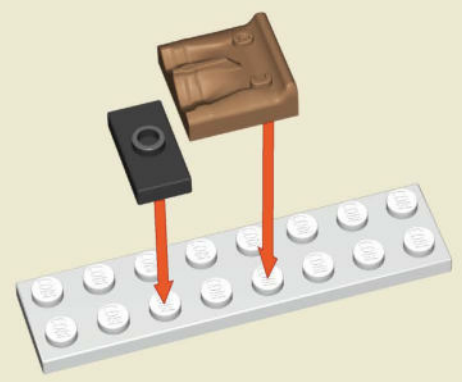

	x1
	x1
	x1

21

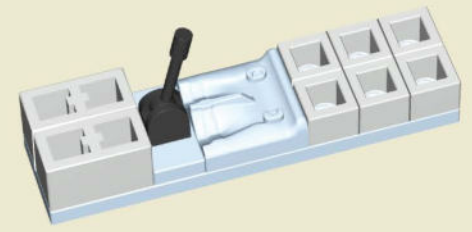

	x1		x1
	x2		x6

22

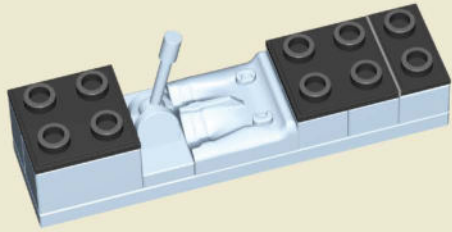

x2



x1

23

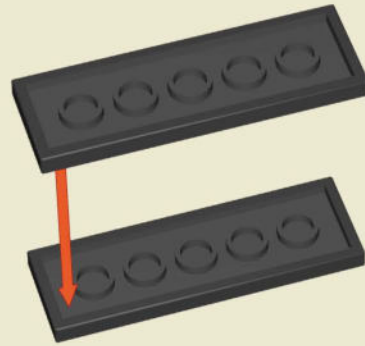

x2

24

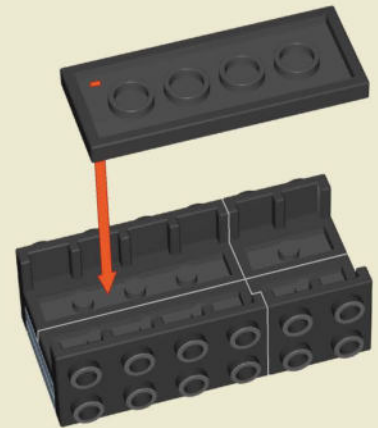

x2



x2



x1

25

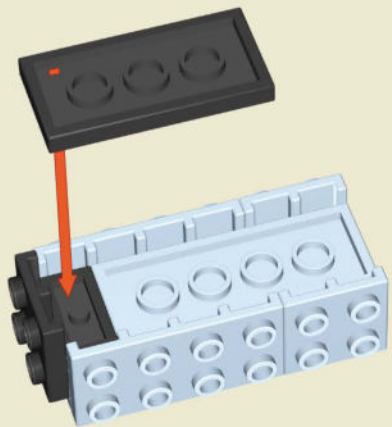

x1



x1

26

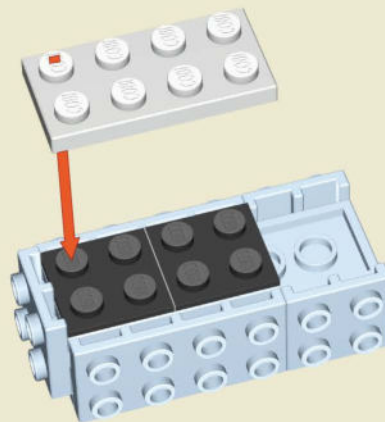

x2



x1

27

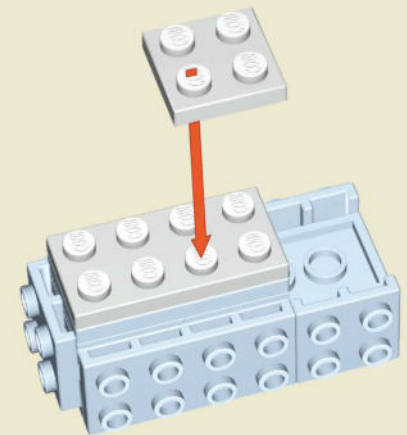

x1



x1

28

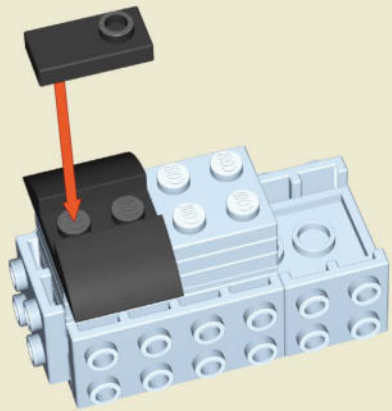

x1



x1

29

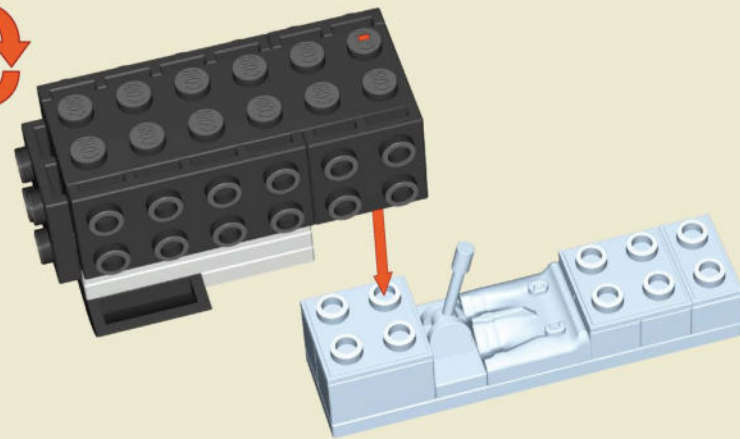

30

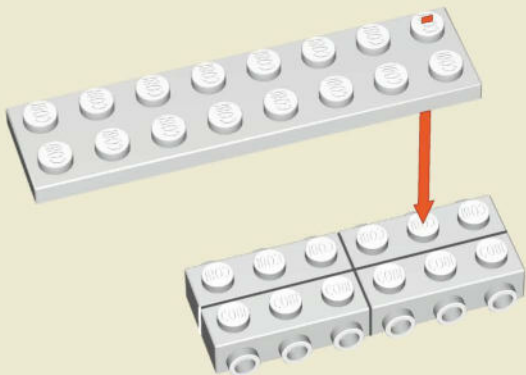

x4



x1

31

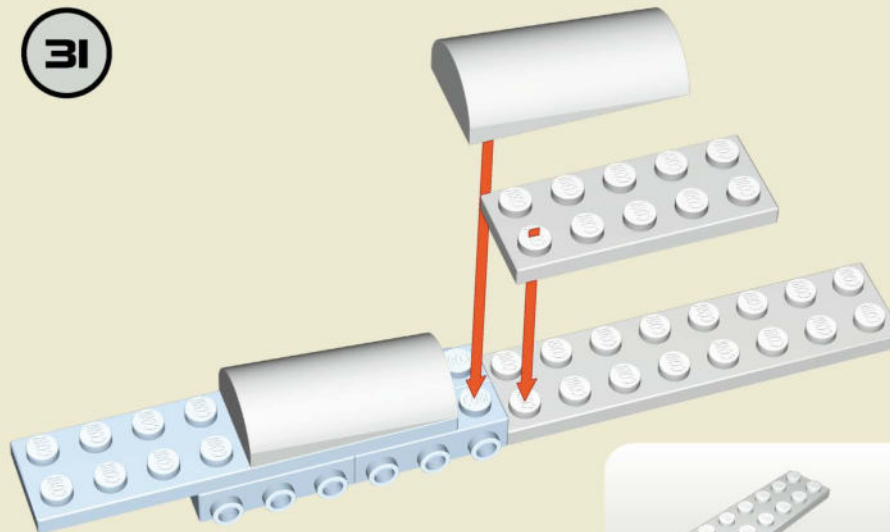

x1



x1

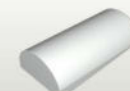

x2

32

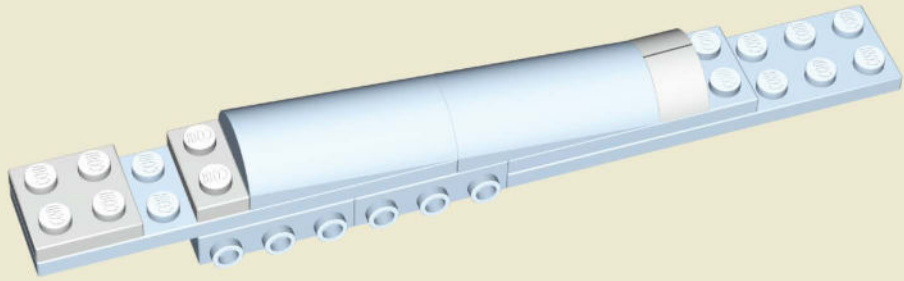

x1



x1



x2

33

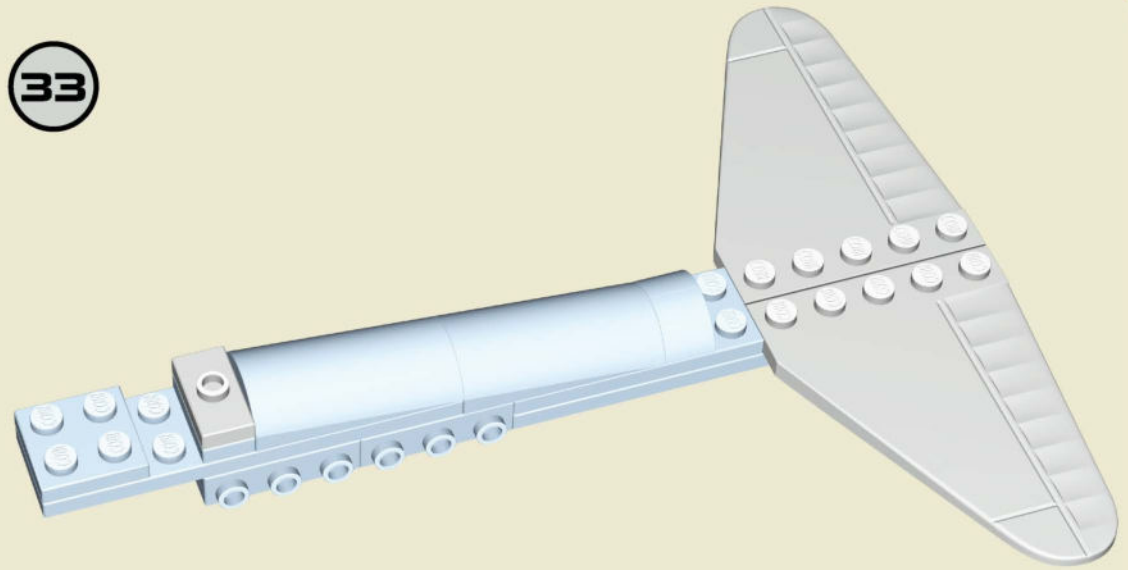

x1



x1



x1

34

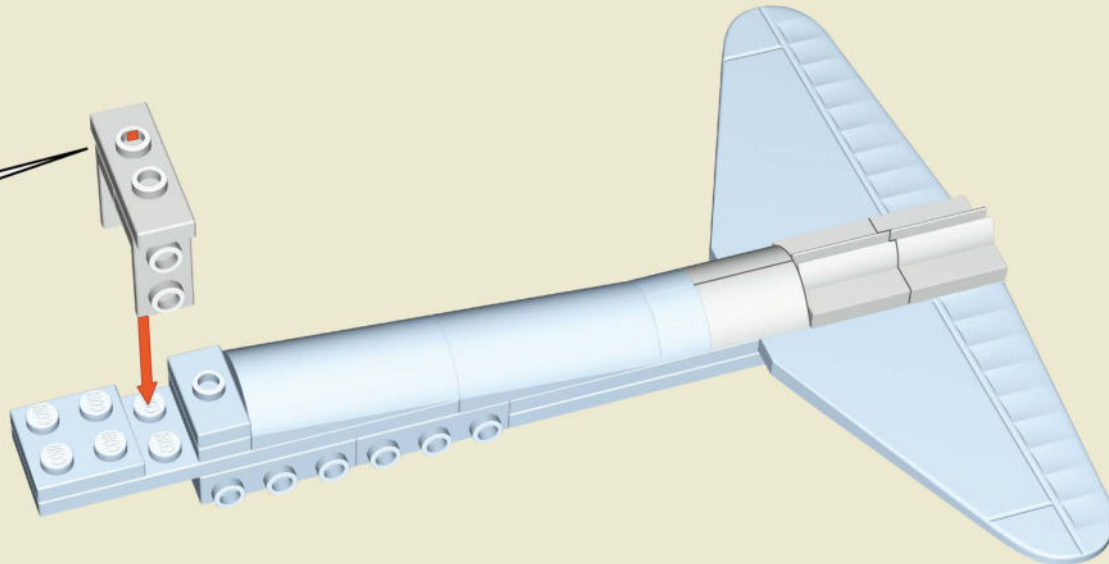
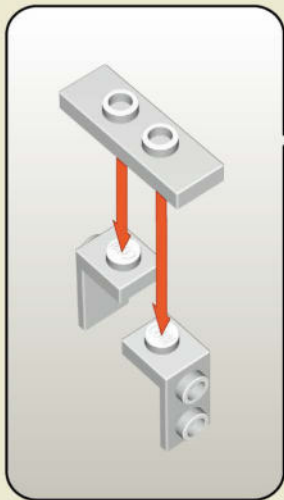

x1



x2



x2



x2

35

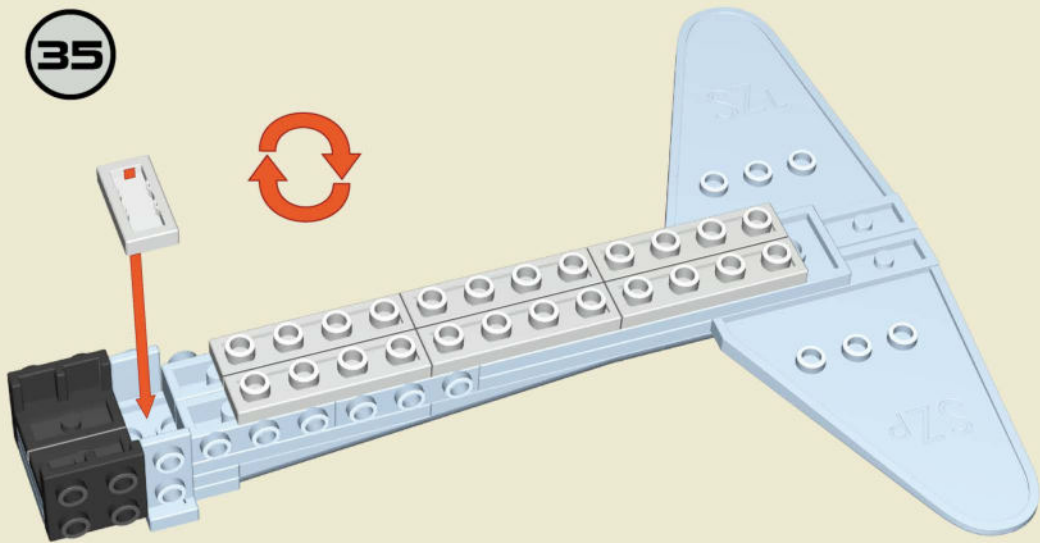

36

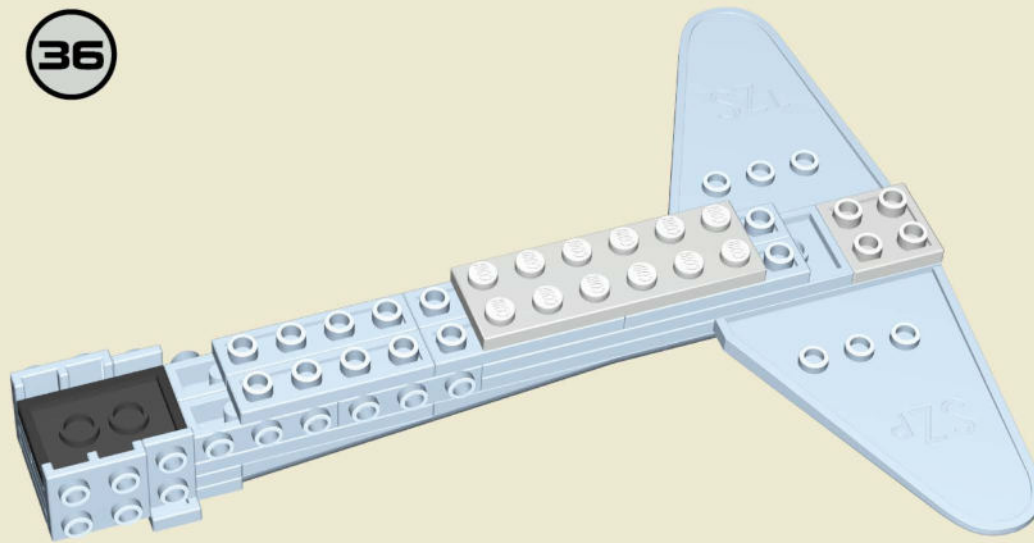

37

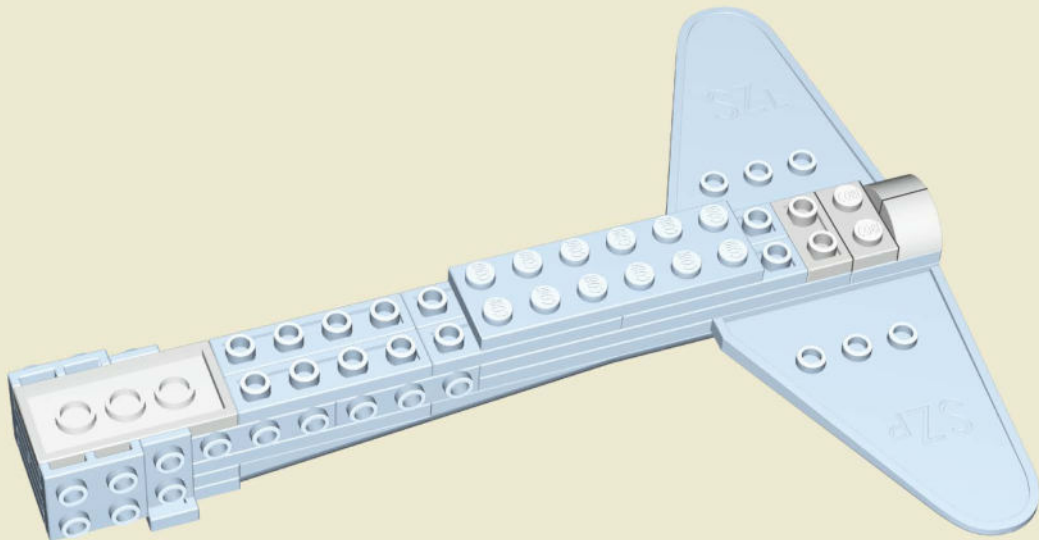

38

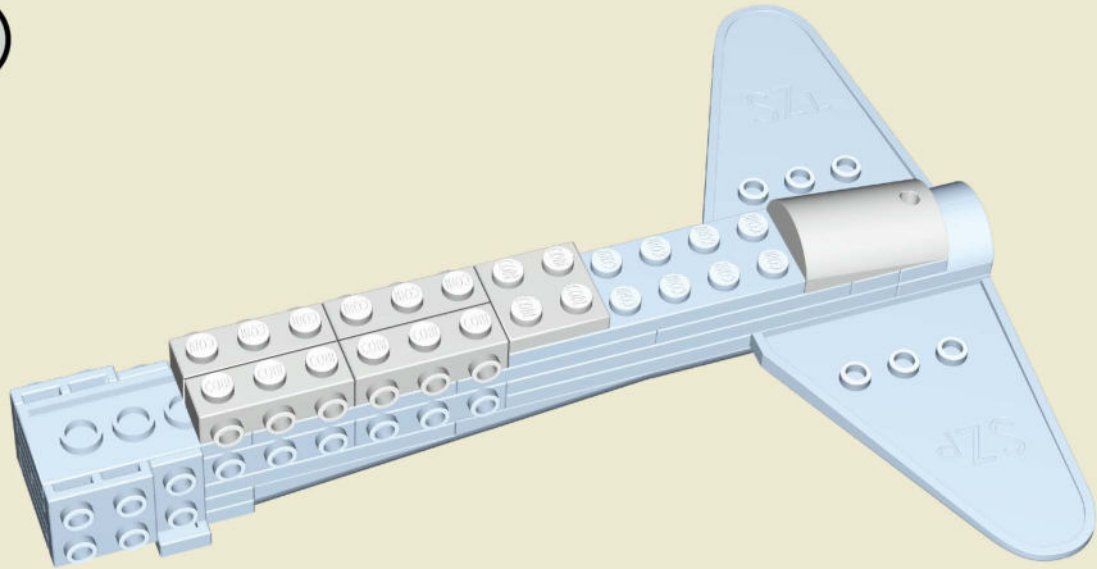

x4



x1

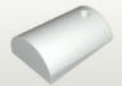

x1

39

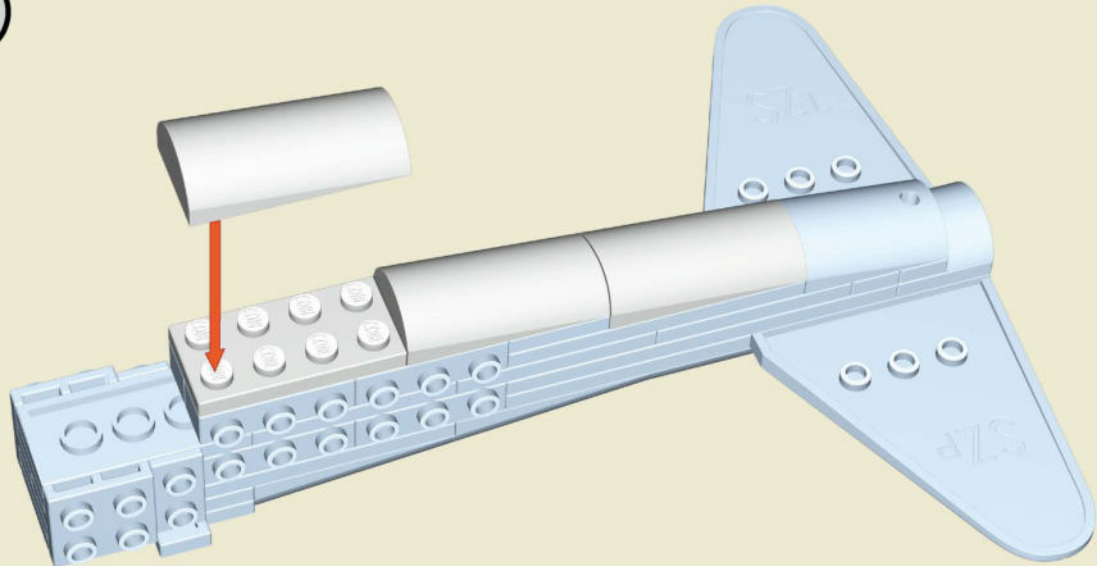

x1

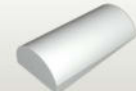

x3

40

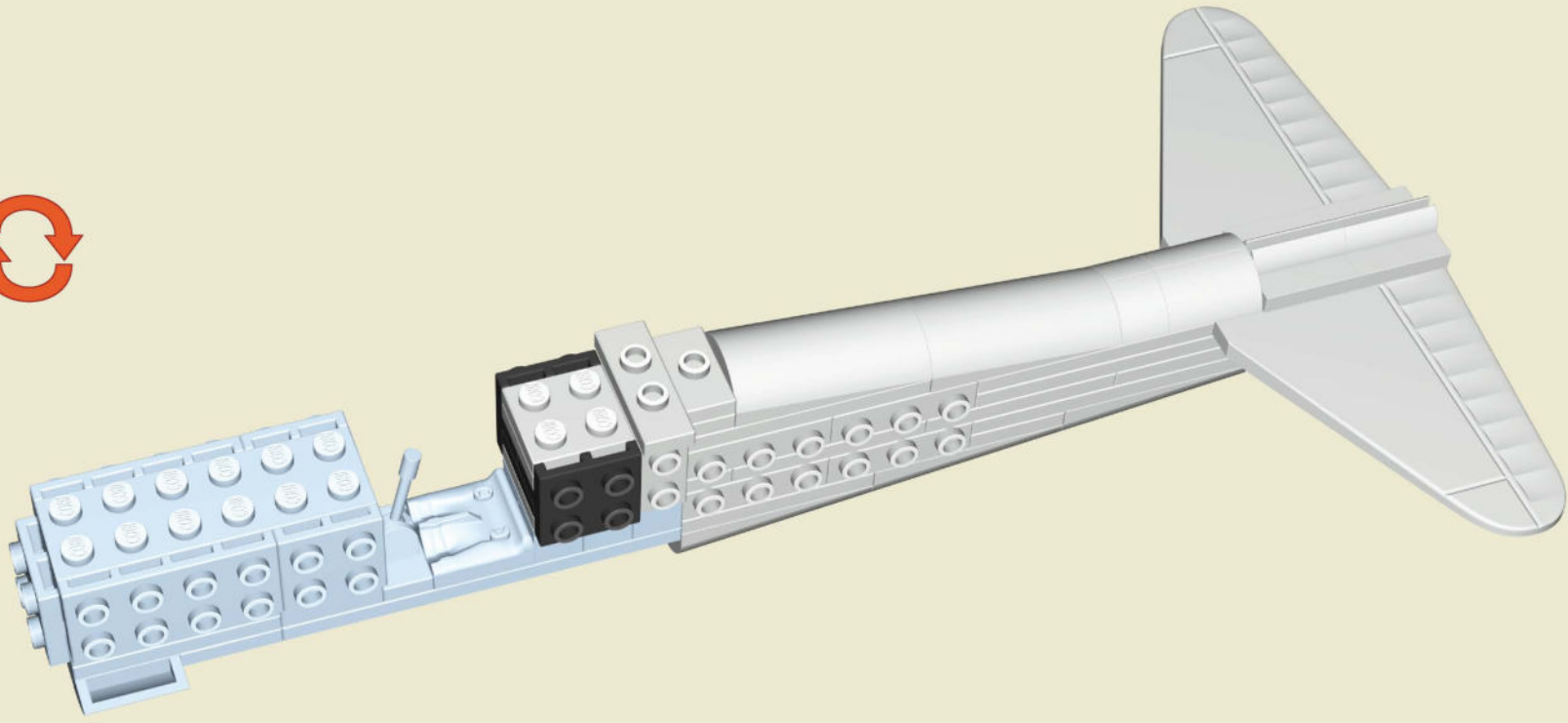

41

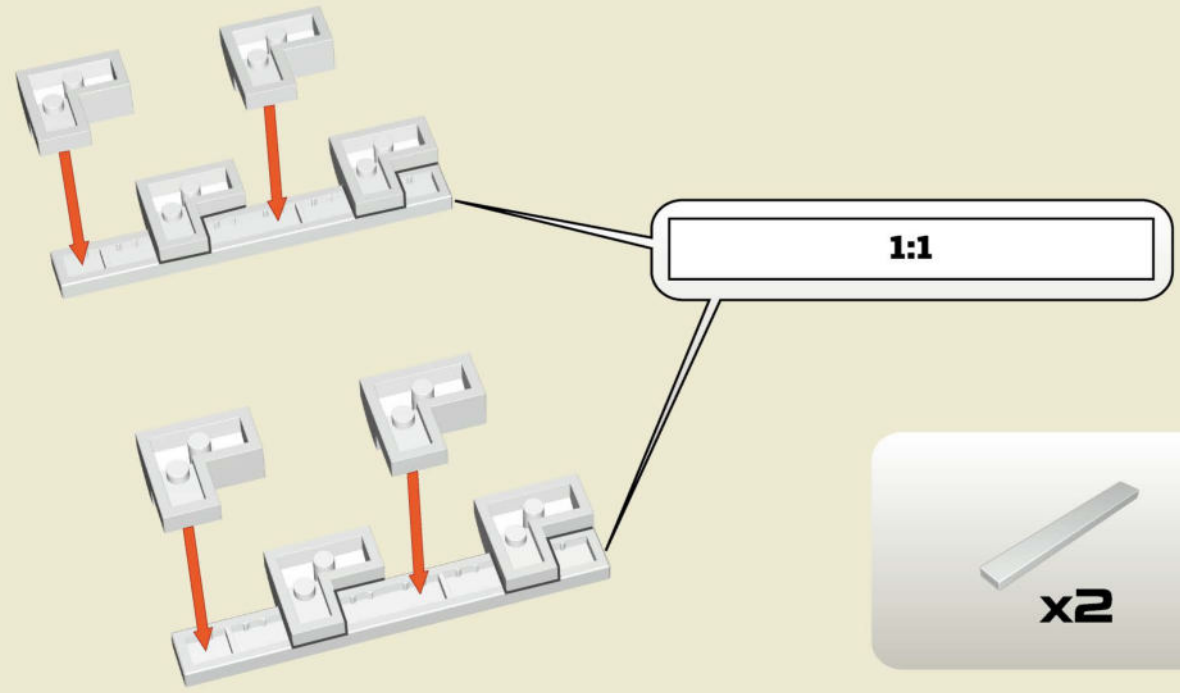

42

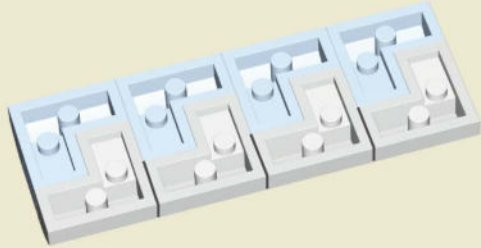
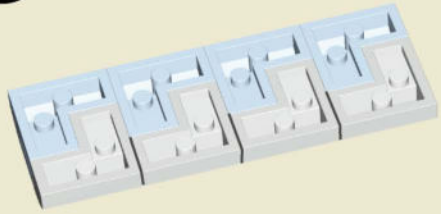

x8

43

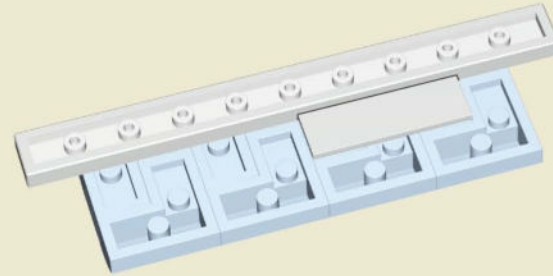
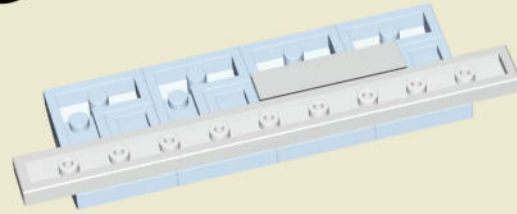

x2



x2

44

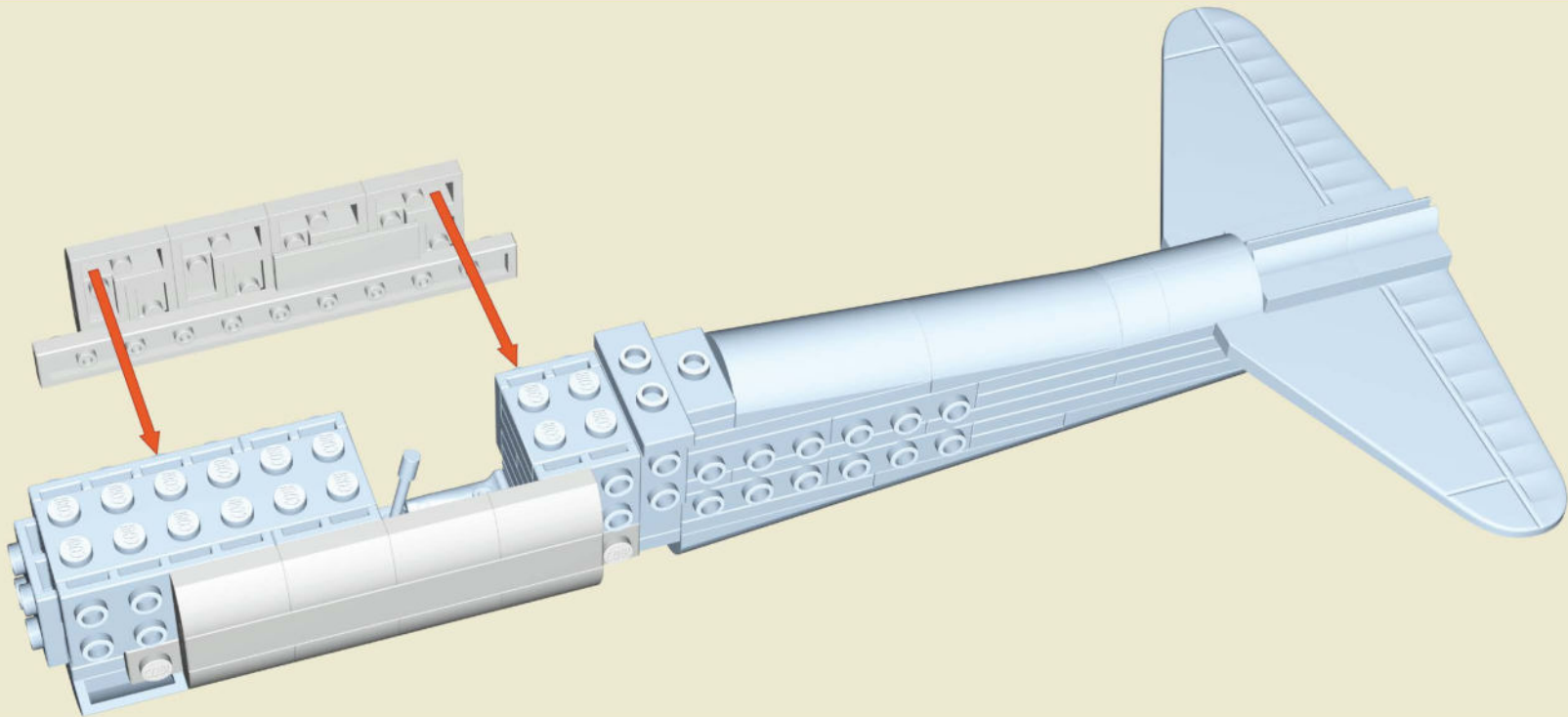

45

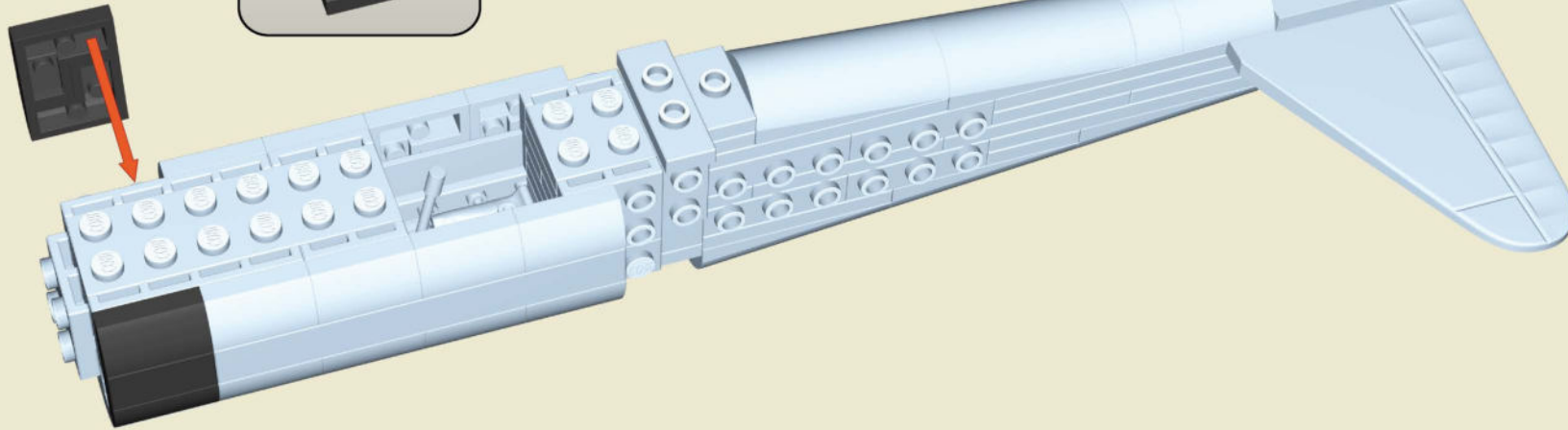
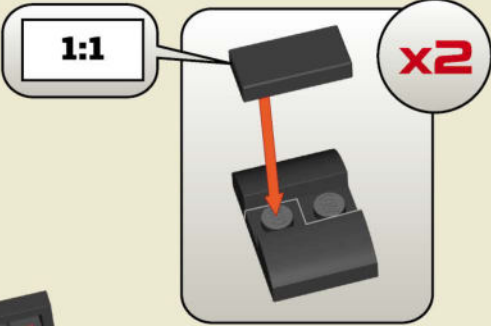

46

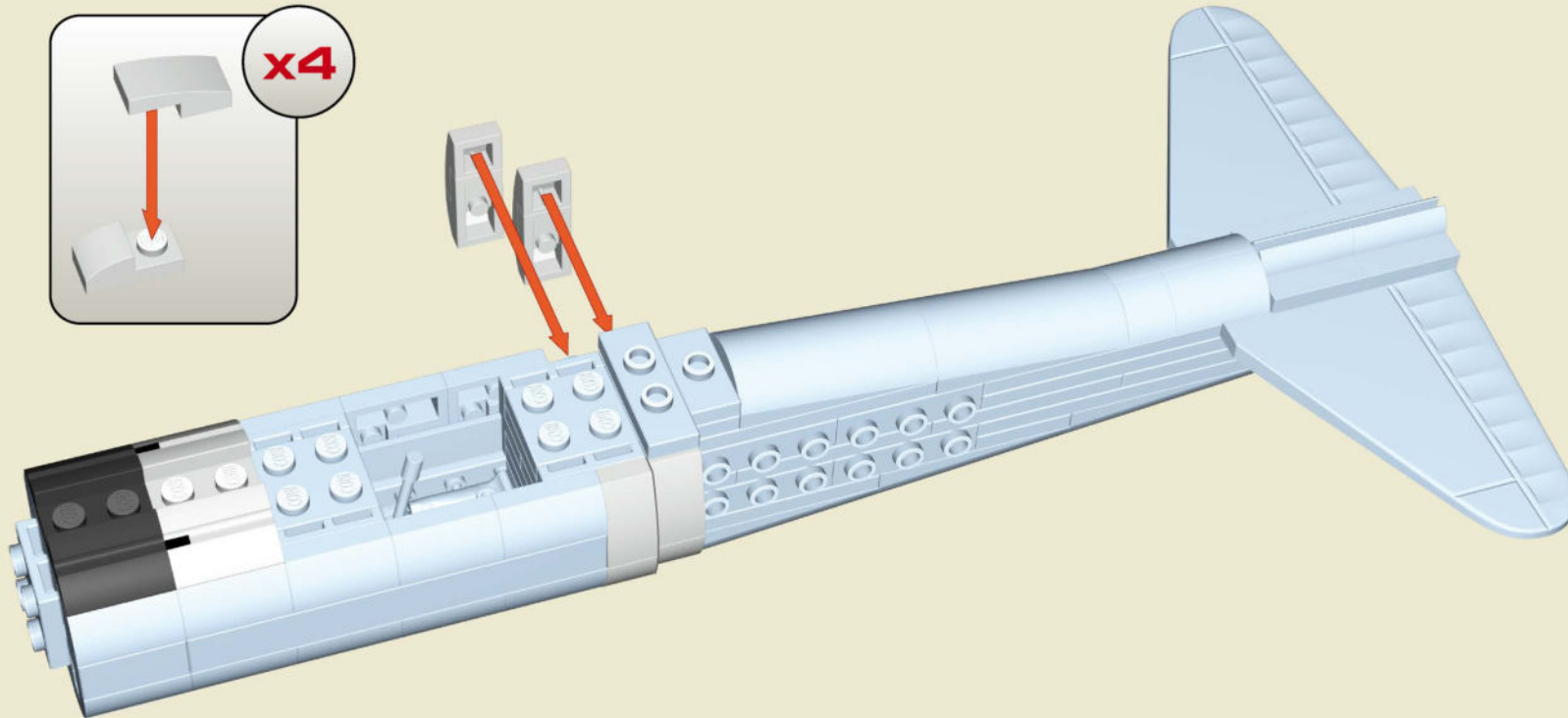

47



x1



x1



x1

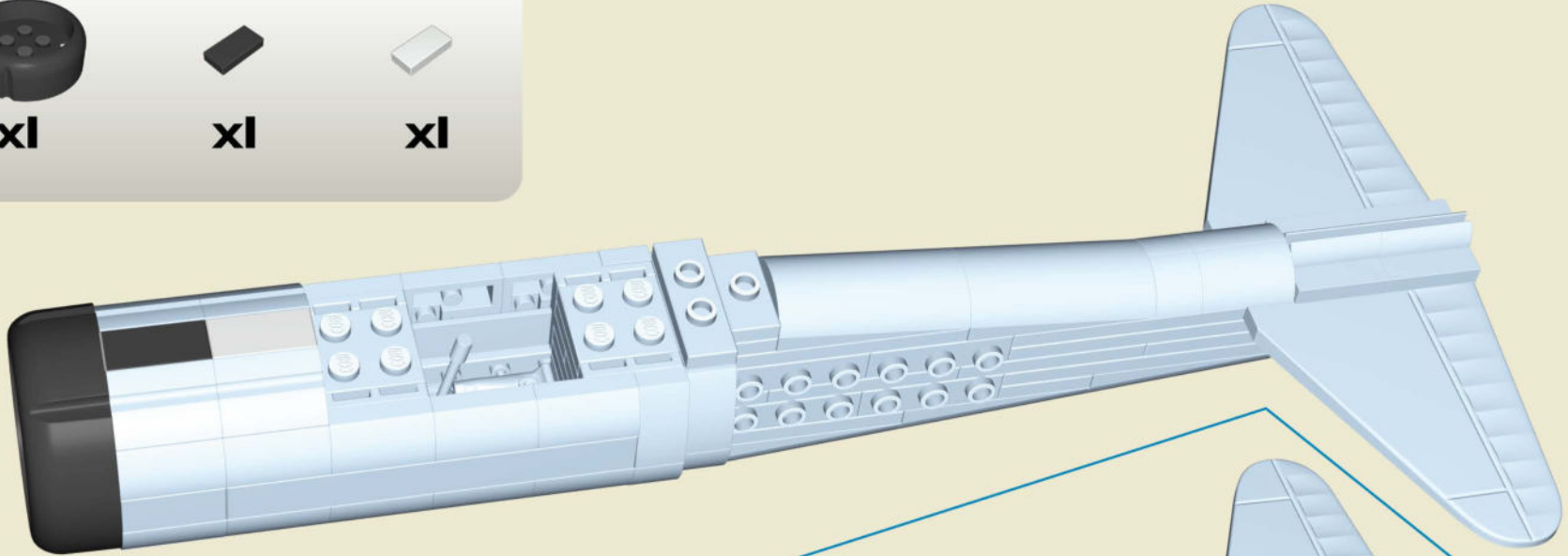

48

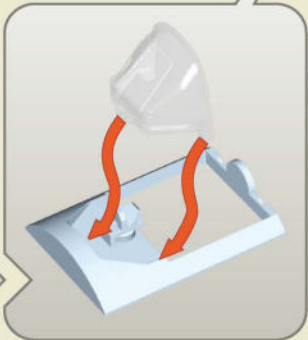
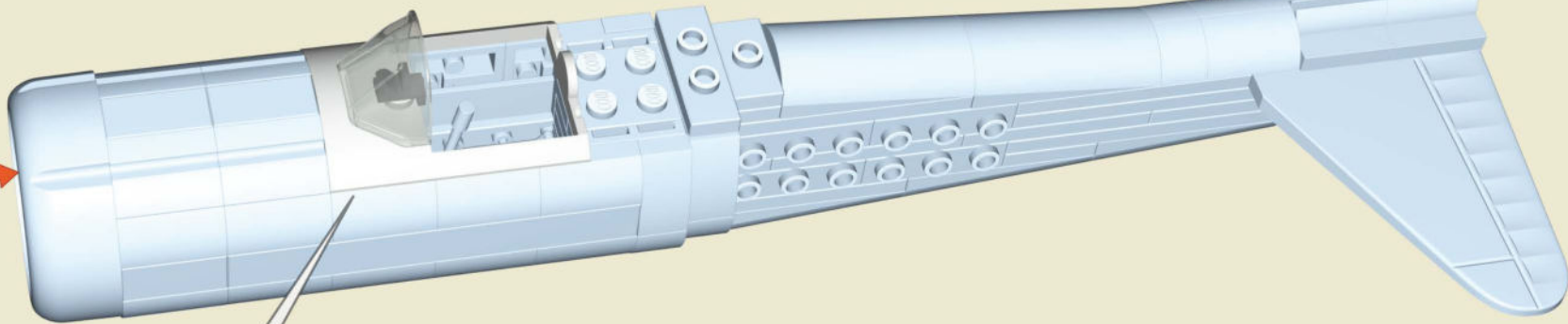

x1



x1



x1



x1

49



x1



x2



x1

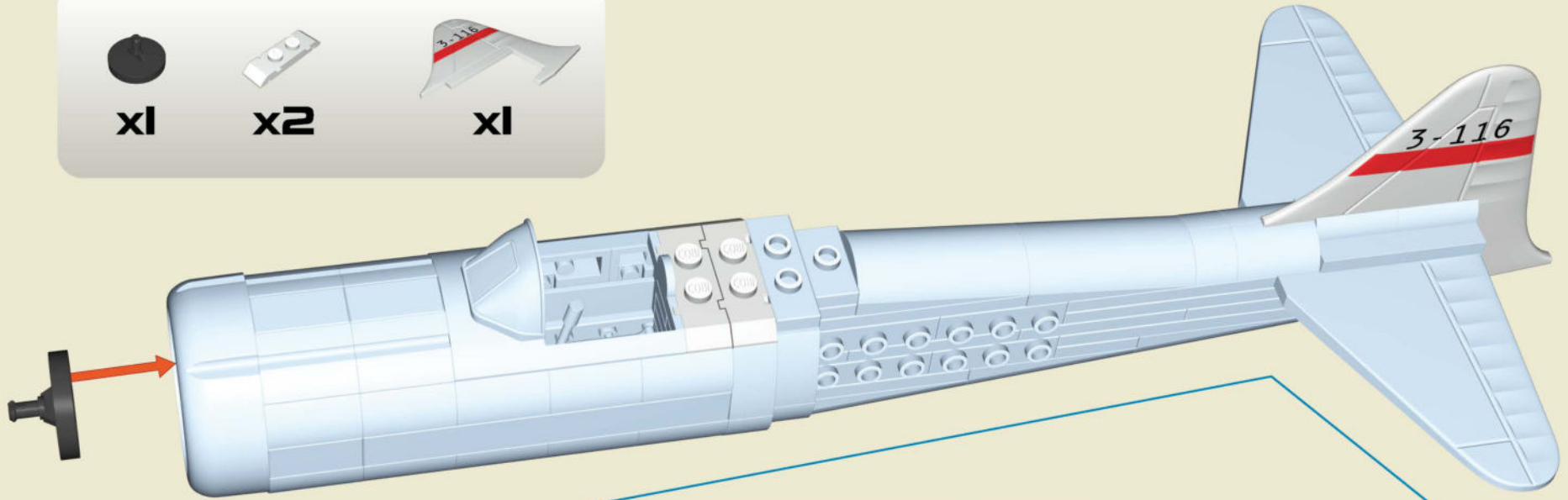

50

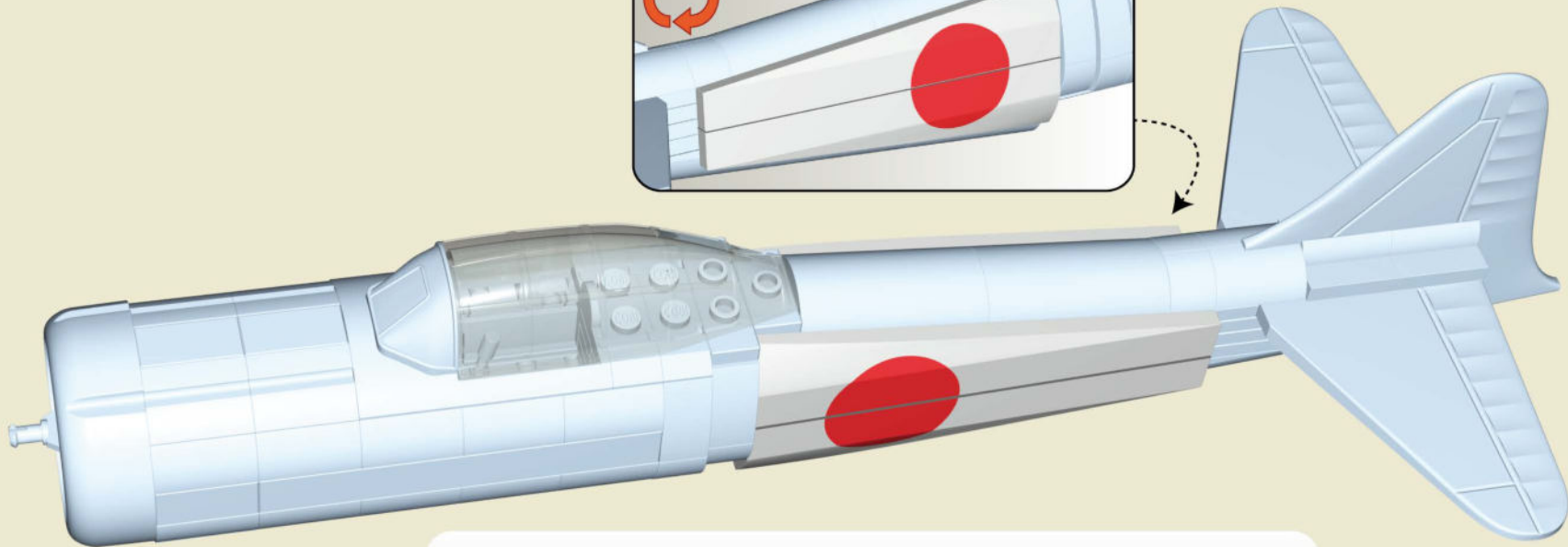
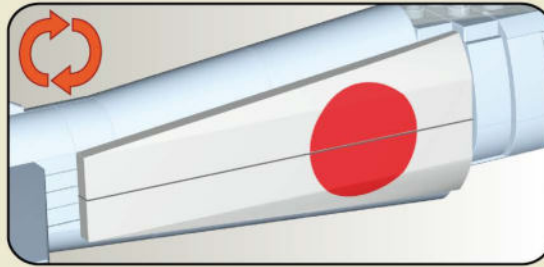

x1



x2



x2

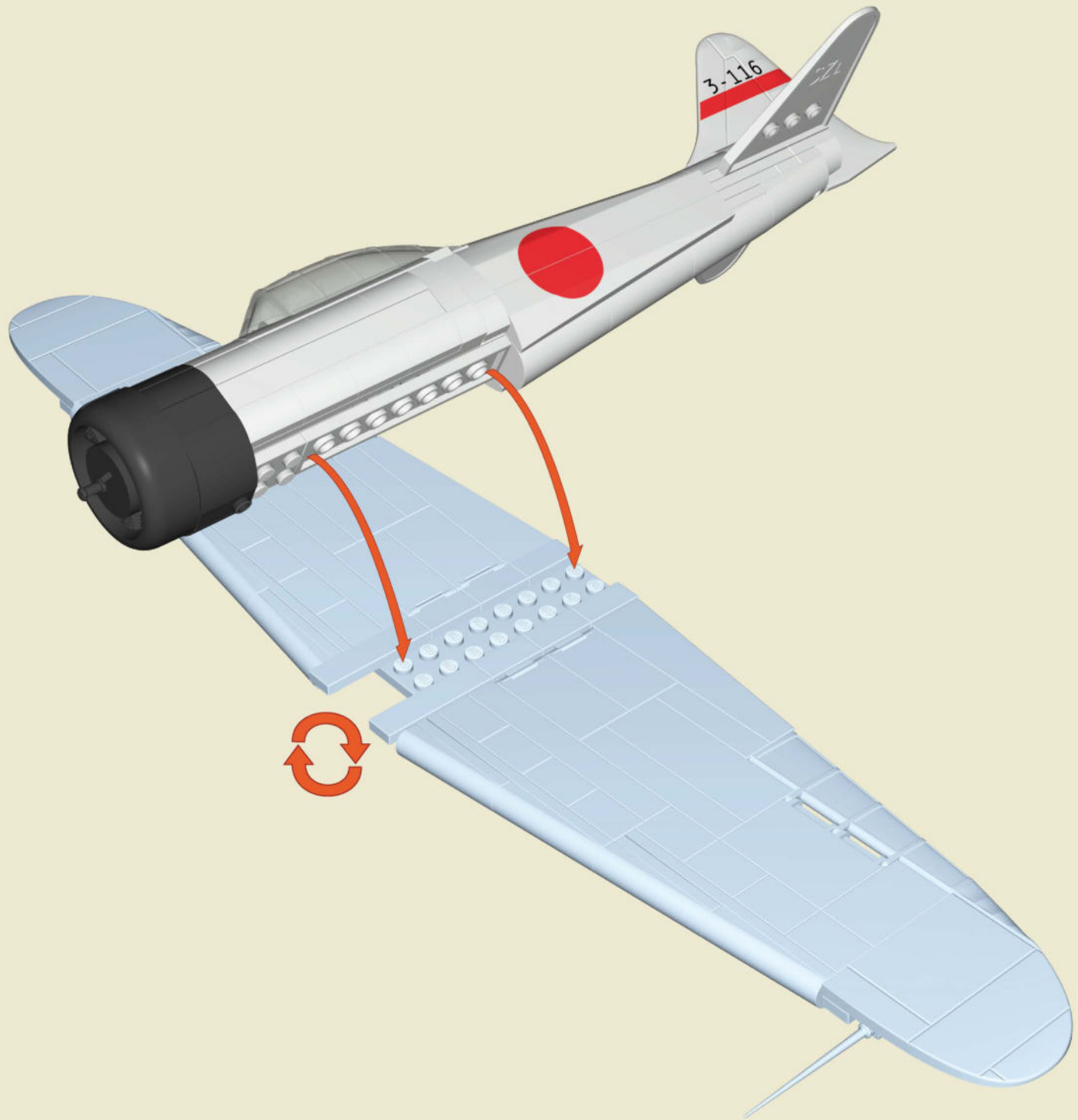

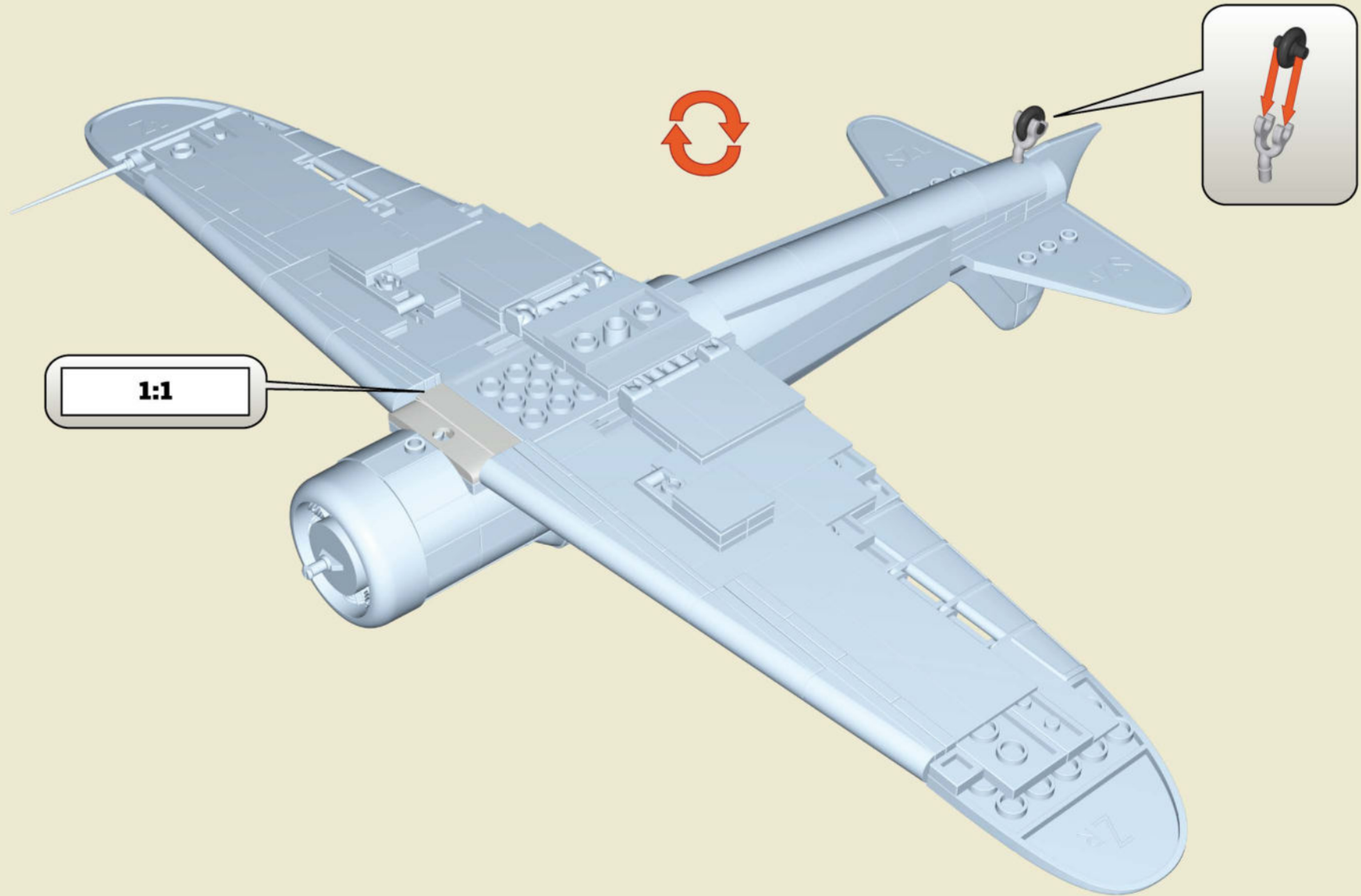

- 
x1
- 
x1
- 
x1
- 
x1

53

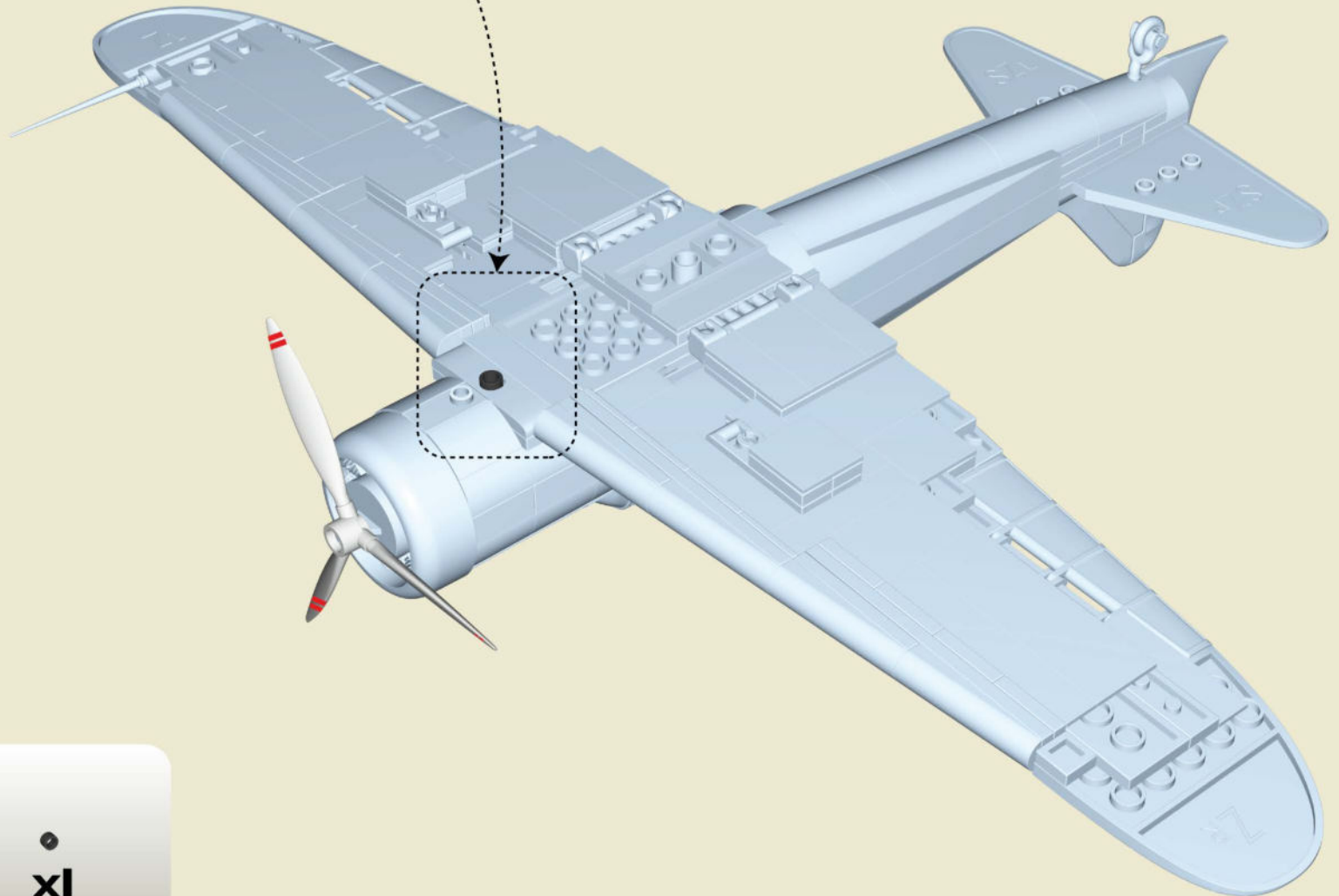
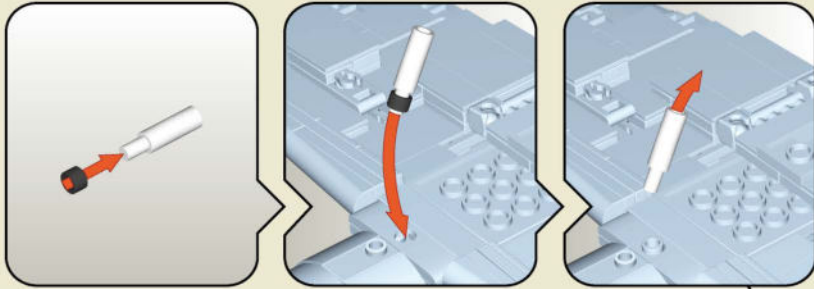

x1



x1

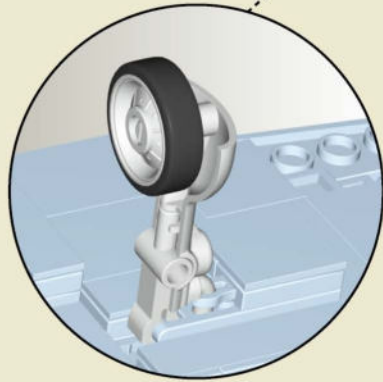
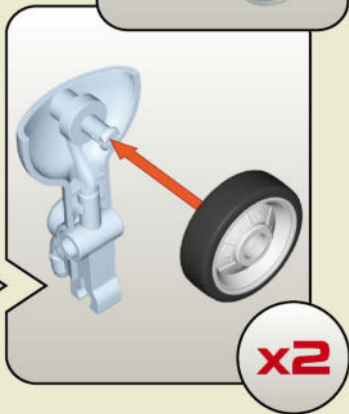
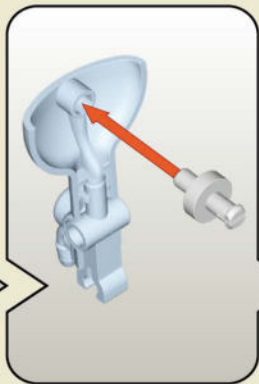
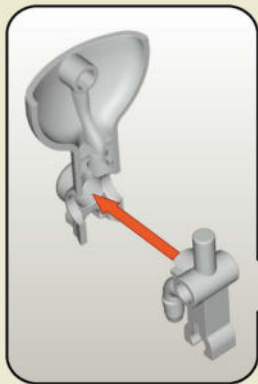
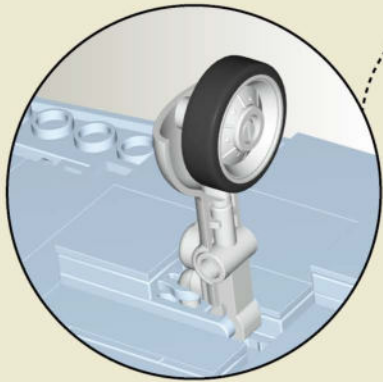

-  x2
-  x2
-  x2
-  x2
-  x2
-  x1
-  x1

55

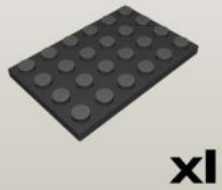
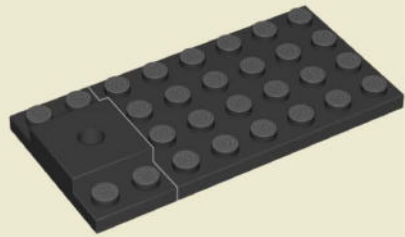

56

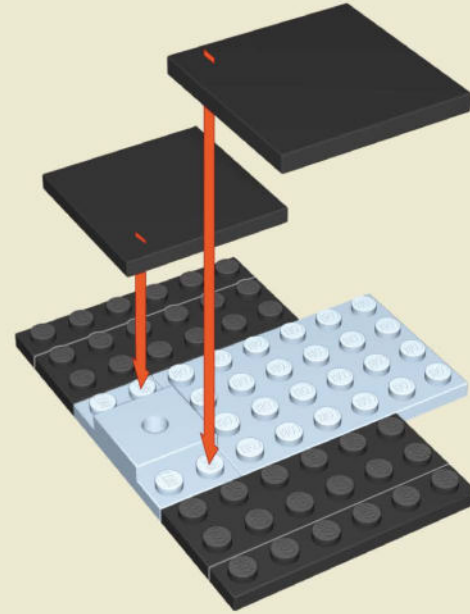

57

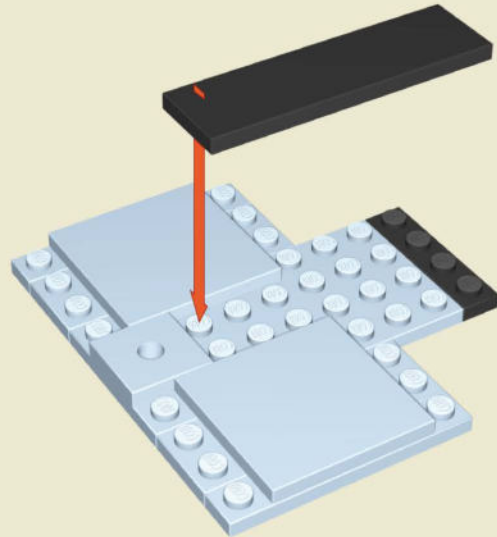

x1



x1

58

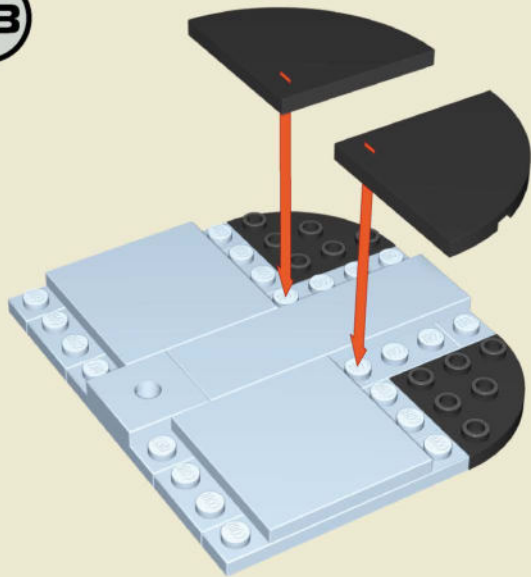

59

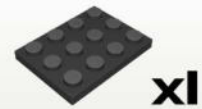
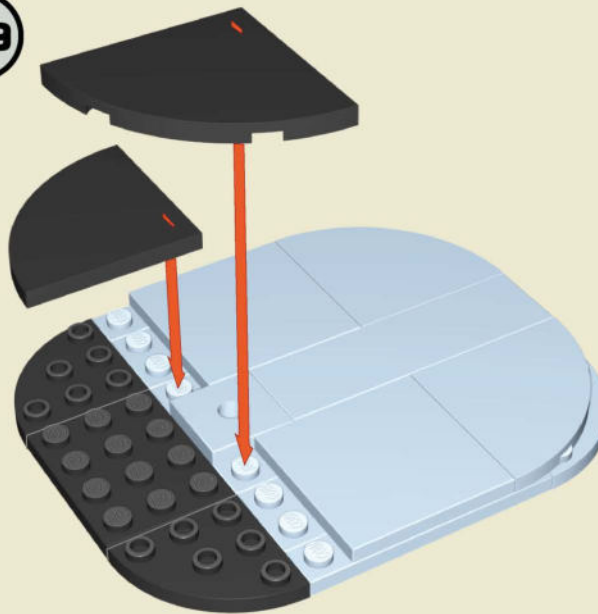

60

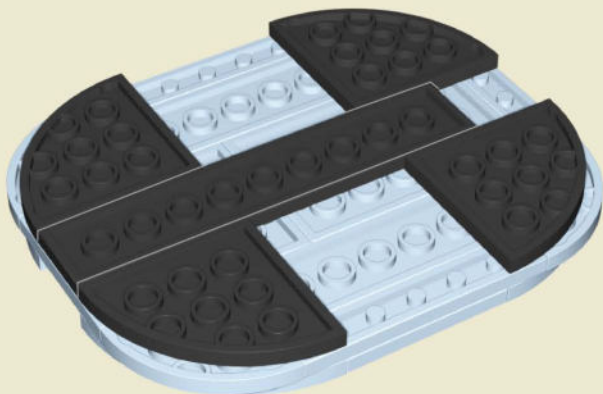

61



1:1

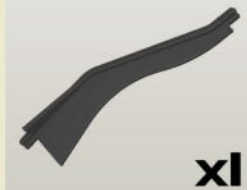
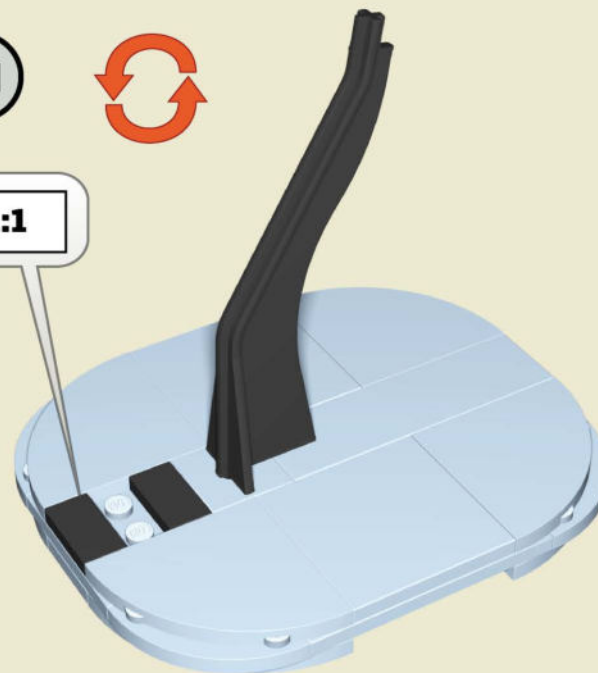

x2

x1

x1

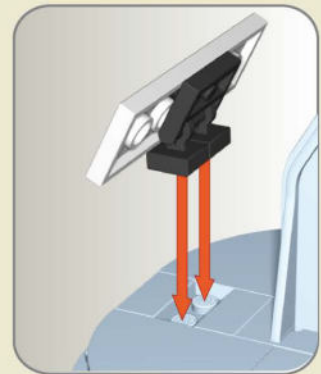
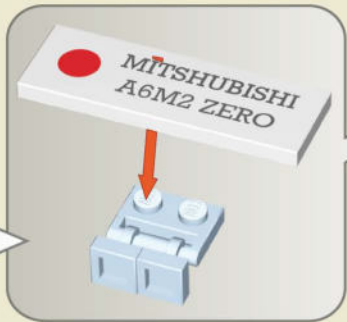
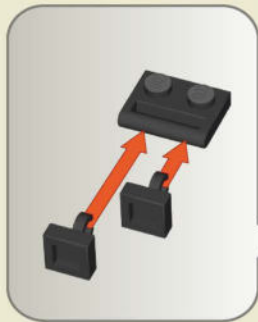
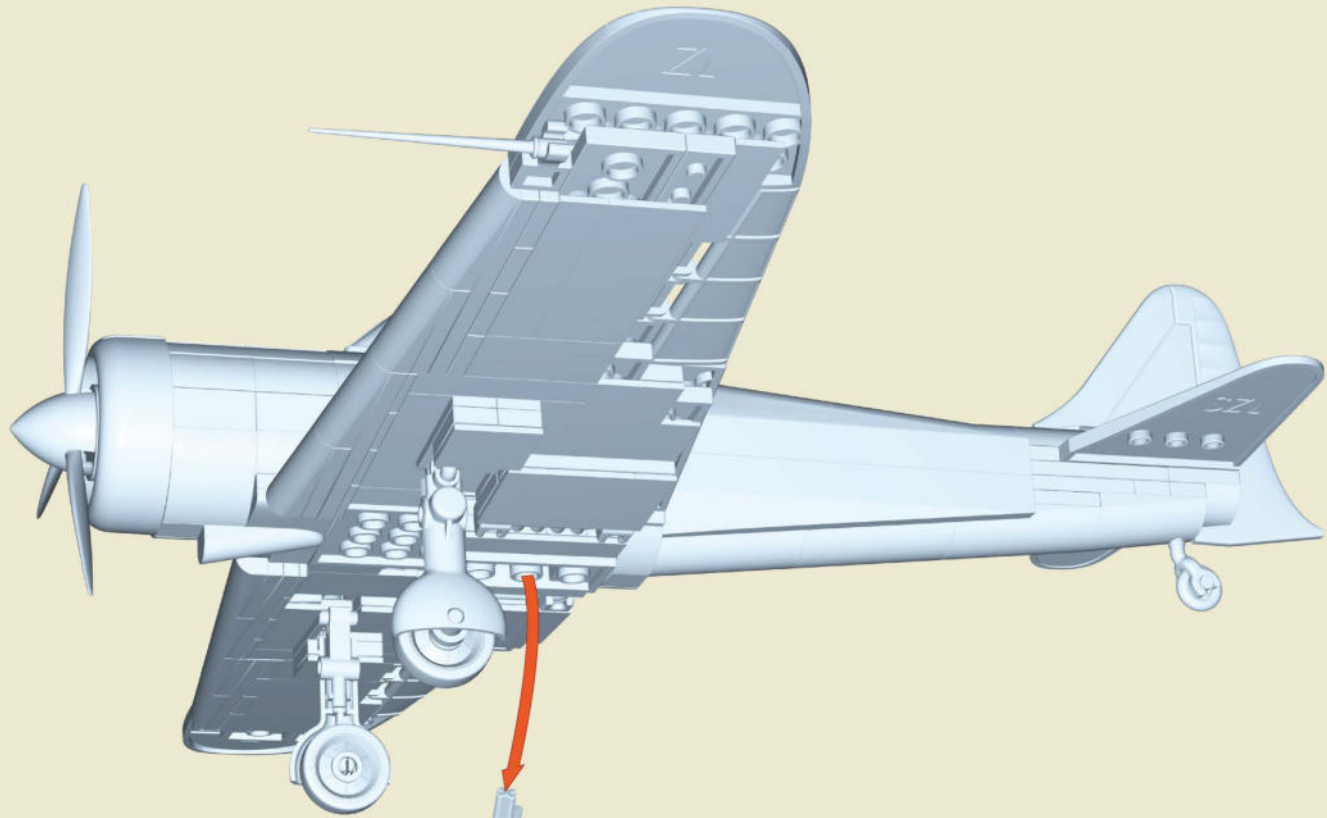
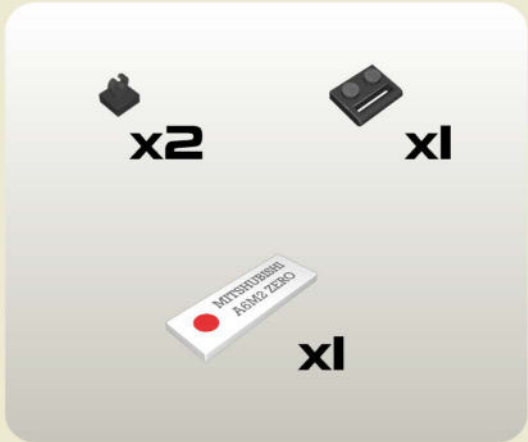





x1
92675



x1
146303



x7
93960



x4
82966



x4
55889



x1
43290



x1
140607



x1
140608



x2
146261



x1
93320



x1
92685



x3
128153



x1
92874



x1
92688



x2
144326



x1
92692



x1
92878



x1
92693



x1
92869

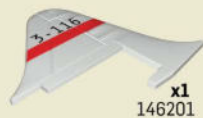

x1
146201



x1
92873



x1
92877



x1
146203



x1
146204



x2
59411



x2
132609



x2
146302



x1
58332



x1
43491



x2
120902



x2
92678



x2
106334



x1
43627



x1
43634



x1
92703



x2
92646

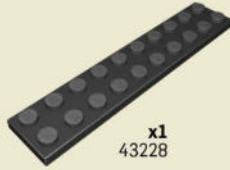

x1
43228



x2
146199



x2
146199

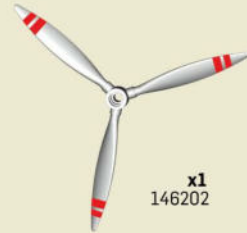

x1
146202



x1
145357



x1
146205



x2
139410



x1
145375



HISTORICAL COLLECTION



MESSERSCHMITT BF 109 E-3
+ 5727



LIM-5 POLISH AIR FORCE 1959
5824



S-102 CZECHOSLOVAK AIR FORCE
5821



LIM-1 POLISH AIR FORCE 1952
5822



For news and special deals